

SELF-LOCK SINGLE PRO

Important Information

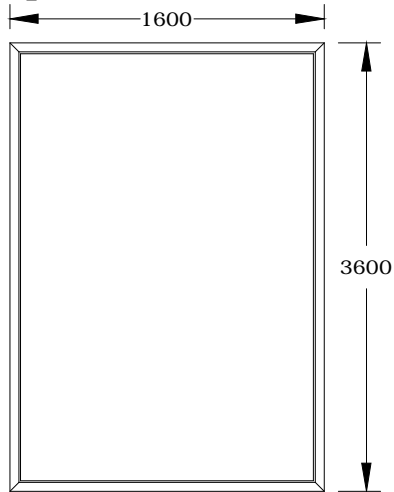

All glass clamping areas are to be cleaned with standard glass cleaning products prior to installation.



do not use thinners

Assembly tool:

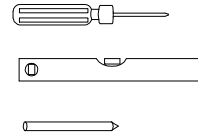
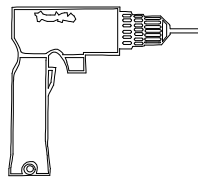

Scope of delivery:

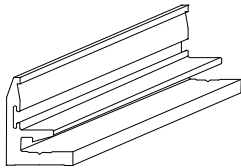

Wall connecting
profile(female)

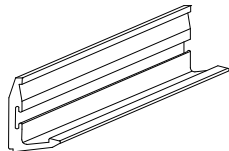

Clamping
profile(male)

Panel dimensions ideal for 10mm
glass only.

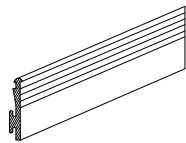

Contact profile(EPDM Std. Rubber)-non removable
after the glass installed.

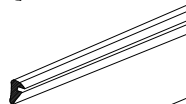

Glass wedge profile for 12 mm glass(EPDM Lock
Rubber for 12mm glass)

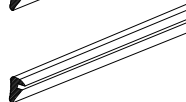

Glass wedge profile for 10mm glass(EPDM Lock Rubber
for 10mm glass)

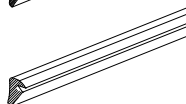

Glass wedge profile for 8 mm glass(EPDM Lock Rubber for
8mm glass)



Disclaimer :
- All Dimensions are indicative
- Adequate structural support for suitable glass dimensions must be considered by the design engineer
- SELFLOCK Systems responsible only for the performance of the locking mechanism of genuine products & assume no responsibility for the incorrect usage of the system.

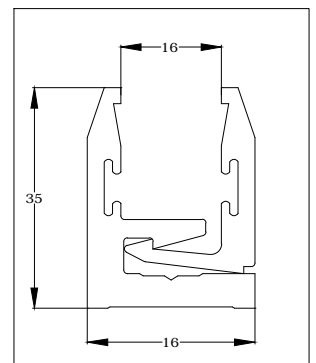

SELF-LOCK SINGLE PRO

1. Assembly of the connecting profile



Screws and plugs for connection are not part of delivery!
please use suitable anchoring system according to
foundation



A level wall / substructure is a necessity for an
assembly without problems.

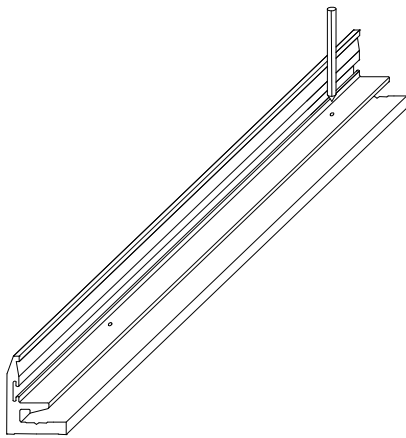
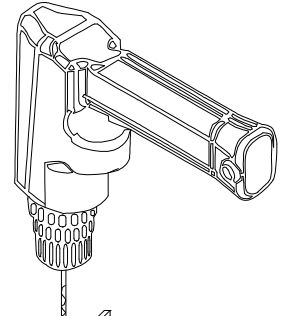

①

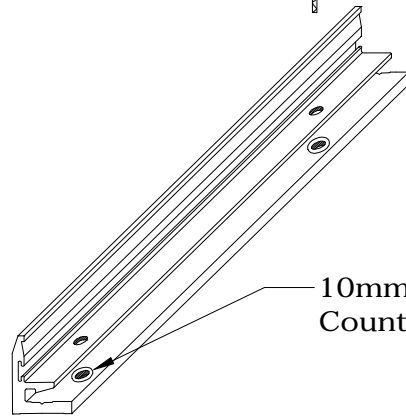

10mm Dia
Countersunk hole

②

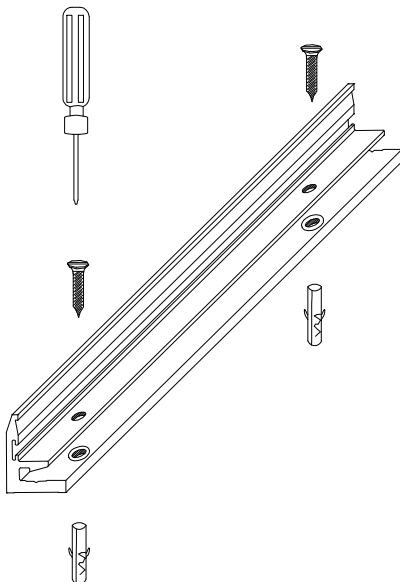

③

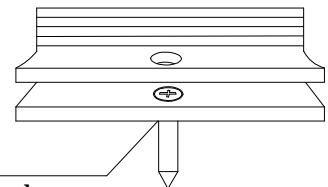

The screw head
must be flush or
completely sunk!

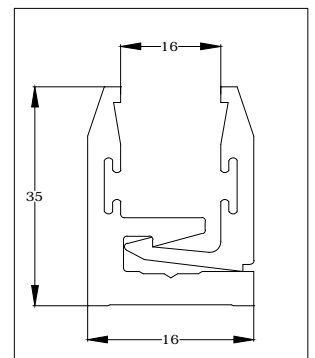

Century
SELF **LOCK**TM
PATENTED
Glazing System

Disclaimer :
- All Dimensions are indicative
- Adequate structural support for suitable glass dimensions must be considered by the design engineer
- SELFLOCK Systems responsible only for the performance of the locking mechanism of genuine products & assume no responsibility for the incorrect usage of the system

SELF-LOCK SINGLE PRO

2. Push in the contact profile

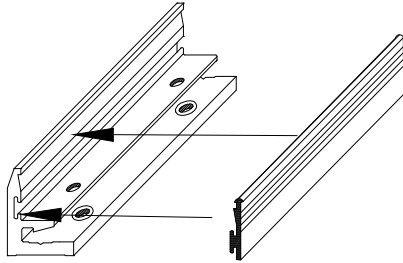

④

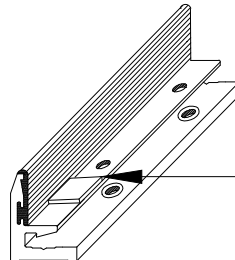
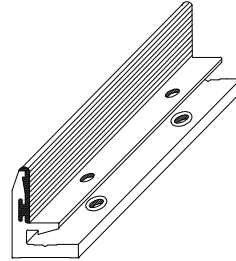

Setting Block Not included in scope of delivery.

⑤

6. Setting up the glass

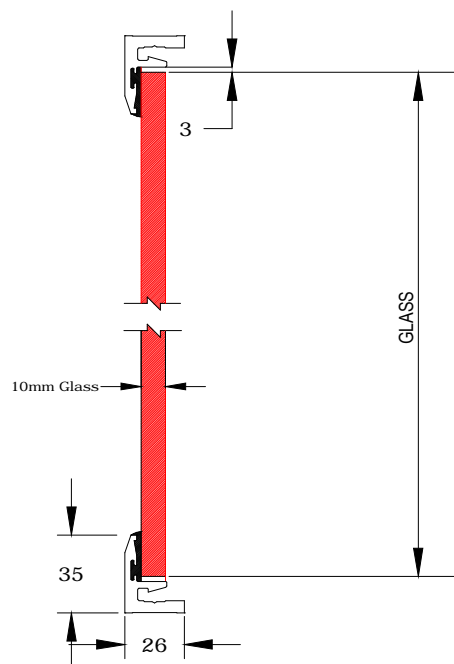

Disclaimer :
- All Dimensions are indicative
- Adequate structural support for suitable glass dimensions must be considered by the design engineer
- SELFLOCK Systems responsible only for the performance of the locking mechanism of genuine products & assume no responsibility for the incorrect usage of the system

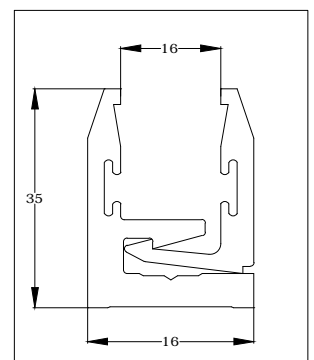

SELF-LOCK SINGLE PRO

3. Assemble the clamping profile 2 and attach the glass wedge profile

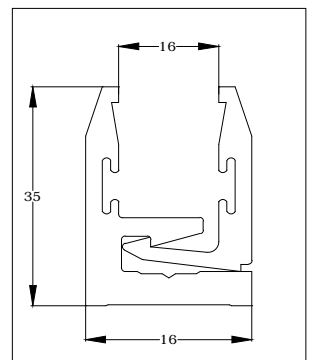
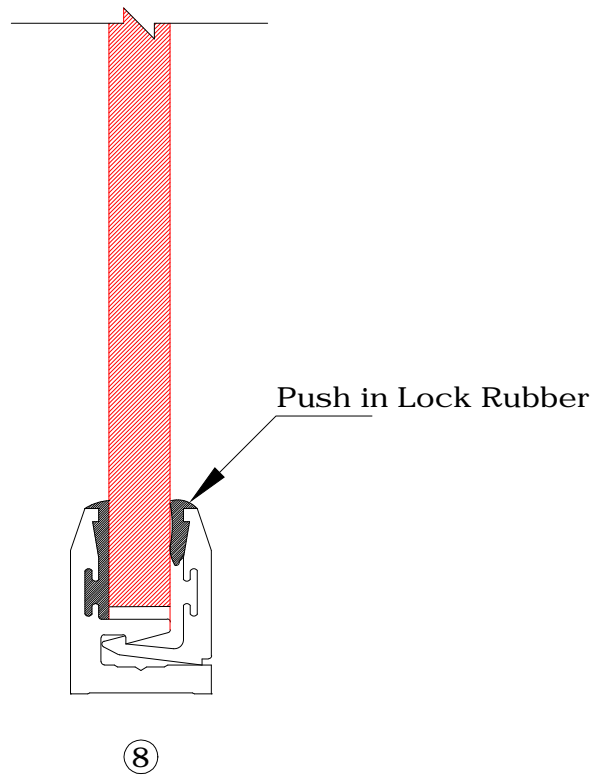
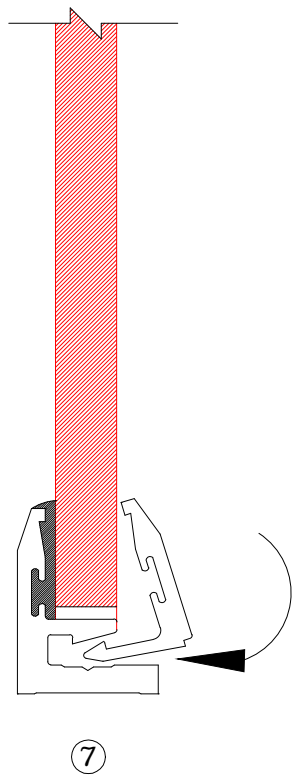

SELF- LOCK MINI PRO

Important Information

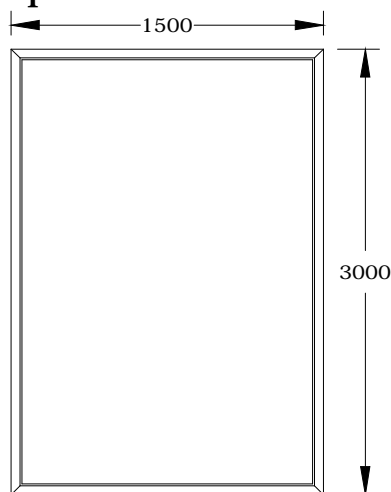

All glass clamping areas are to be cleaned with standard glass cleaning products prior to installation.



do not use thinners

Assembly tool:

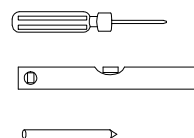
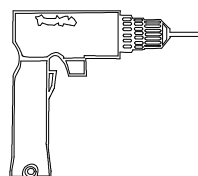

Scope of delivery:

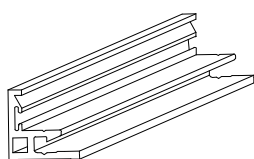

Wall connecting profile(female)

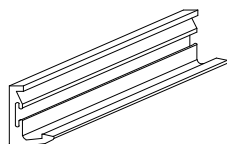

Clamping profile(male)

Panel dimensions ideal for 10mm glass only.

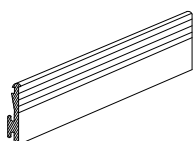

Contact profile(EPDM Std. Rubber)-non removable after the glass installed.

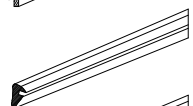

Glass wedge profile for 12 mm glass(EPDM Lock Rubber for 12mm glass)



Glass wedge profile for 10mm glass(EPDM Lock Rubber for 10mm glass)

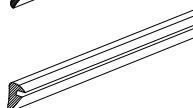

Glass wedge profile for 8 mm glass(EPDM Lock Rubber for 8mm glass)



Disclaimer :
 - All Dimensions are indicative
 - Adequate structural support for suitable glass dimensions must be considered by the design engineer
 - SELFLOCK Systems responsible only for the performance of the locking mechanism of genuine products & assume no responsibility for the incorrect usage of the system

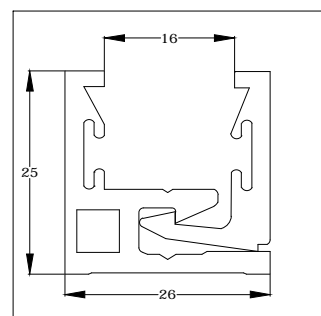

SELF- LOCK MINI PRO

1. Assembly of the connecting profile



Screws and plugs for connection are not part of delivery!
please use suitable anchorsystem according to
foundation



A level wall / substructure is a necessity for an
assembly without problems.

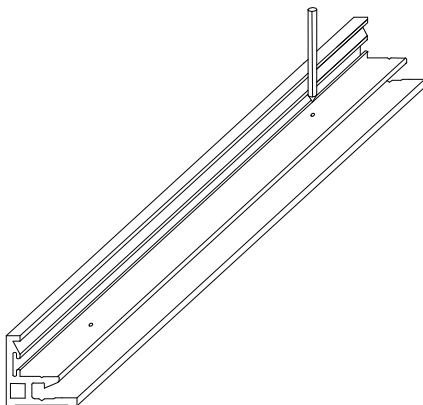

①

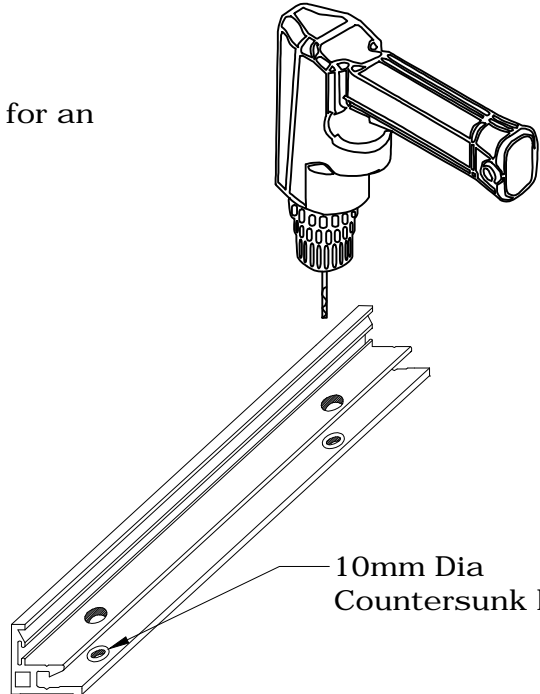

②

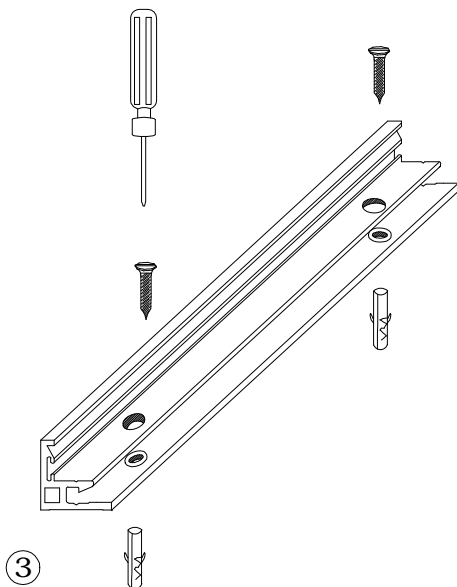

③

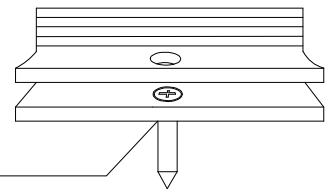

The screw head
must be flush or
completely sunk!



Disclaimer :
- All Dimensions are indicative
- Adequate structural support for suitable glass dimensions must be considered by the design engineer
- SELFLOCK Systems responsible only for the performance of the locking mechanism of genuine products & assume no responsibility for the incorrect usage of the system

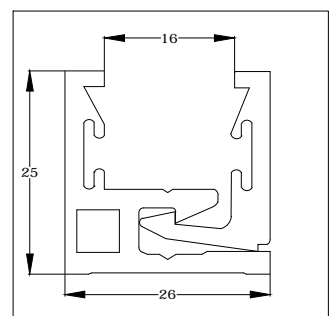

SELF- LOCK MINI PRO

2. Push in the contact profile

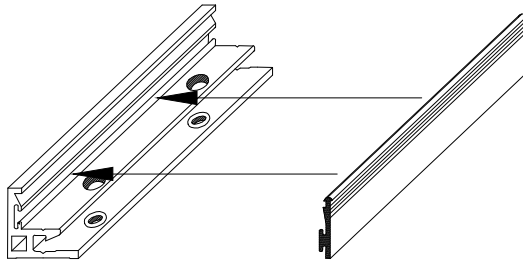

④

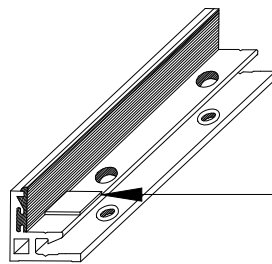
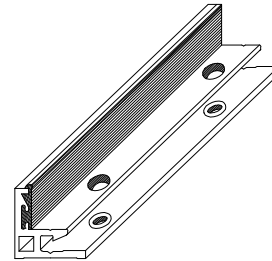

Setting Block Not included in scope of delivery.

⑤

6. Setting up the glass

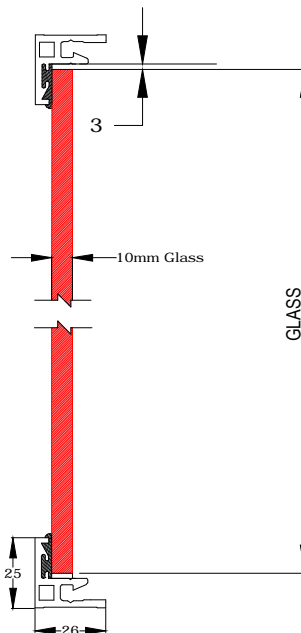

Disclaimer :
- All Dimensions are indicative
- Adequate structural support for suitable glass dimensions must be considered by the design engineer
- SELFLOCK Systems responsible only for the performance of the locking mechanism of genuine products & assume no responsibility for the incorrect usage of the system

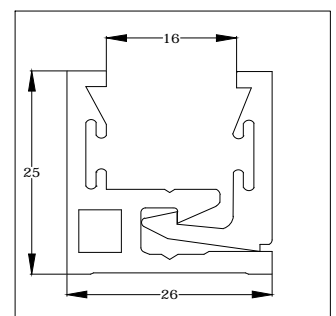

SELF- LOCK MINI PRO

3. Assemble the clamping profile 2 and attach the glass wedge profile

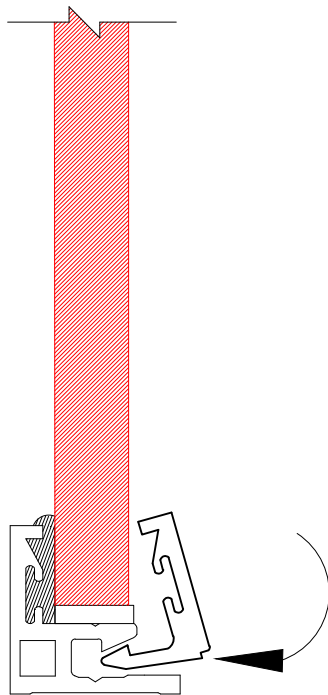

⑦

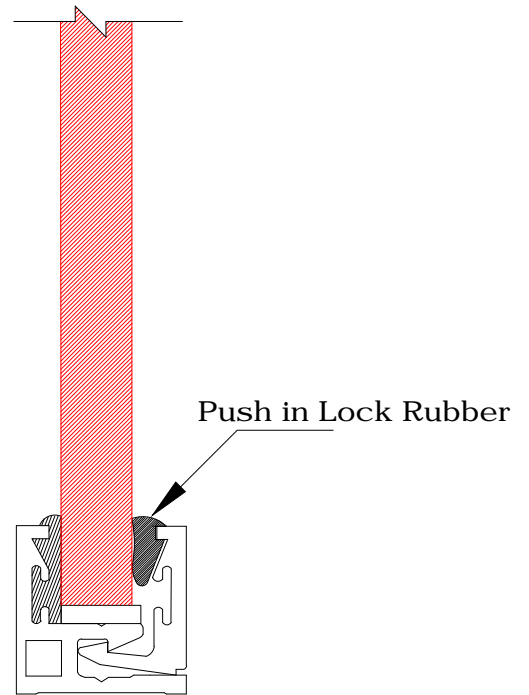

⑧



Disclaimer :
- All Dimensions are indicative
- Adequate structural support for suitable glass dimensions must be considered by the design engineer
- SELFLOCK Systems responsible only for the performance of the locking mechanism of genuine products & assume no responsibility for the incorrect usage of the system

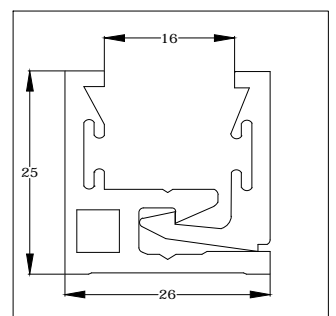

SELF-LOCK BOTTOM PRO

(COMBINATION WITH SINGLE PRO AT SIDES & TOP)

Important Information

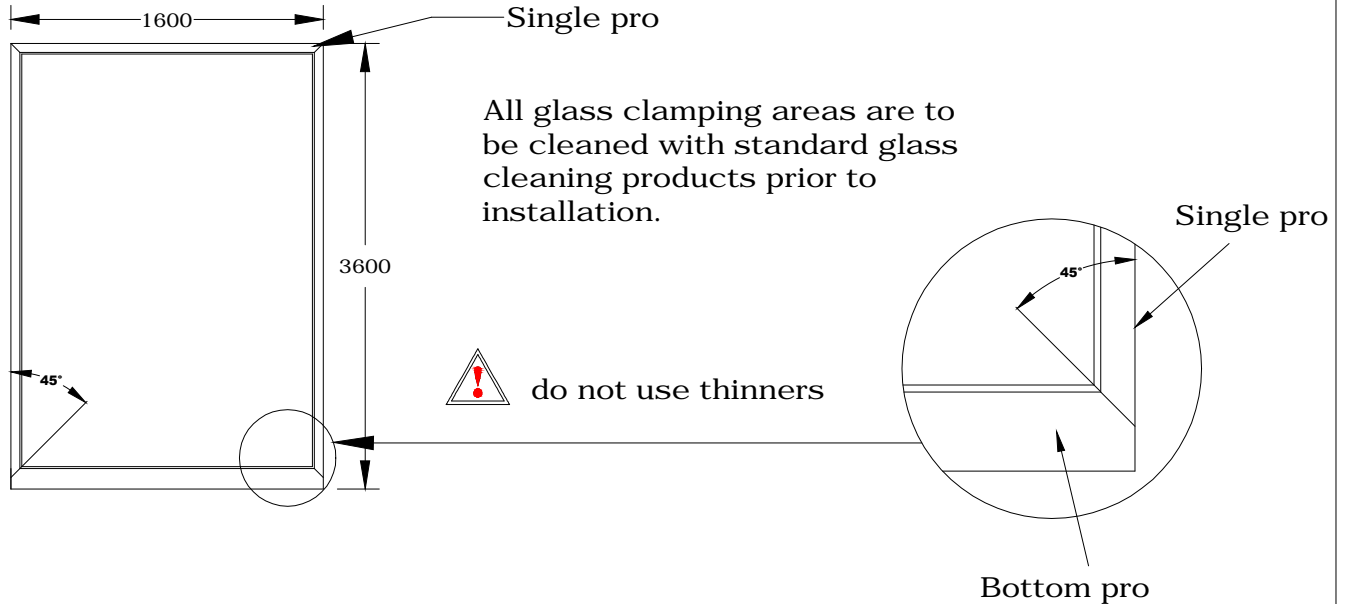

Scope of delivery:

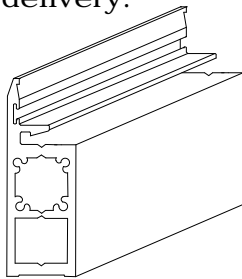

Wall connecting
profile(female)

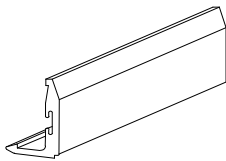

Clamping profile(male)

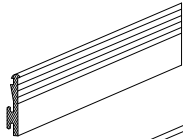

Contact profile(EPDM Std. Rubber)-non removable after the glass installed.



Glass wedge profile for 12 mm glass(EPDM Lock Rubber for 12mm glass)



Glass wedge profile for 10mm glass(EPDM Lock Rubber for 10mm glass)



Glass wedge profile for 8 mm glass(EPDM Lock Rubber for 8mm glass)

Assembly tool:

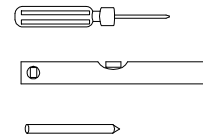
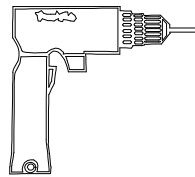

Panel dimensions ideal for
10mm glass only.



Disclaimer :
- All Dimensions are indicative
- Adequate structural support for suitable glass dimensions must be considered by the design engineer
- SELFLOCK Systems responsible only for the performance of the locking mechanism of genuine products & assume no responsibility for the incorrect usage of the system

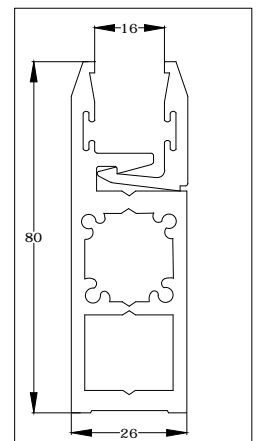

SELF-LOCK BOTTOM PRO

(COMBINATION WITH SINGLE PRO AT SIDES & TOP)

1. Assembly of the connecting profile



Screws and plugs for connection are not part of delivery!
please use suitable anchor system according to foundation



A level wall / substructure is a necessity for an assembly without problems.

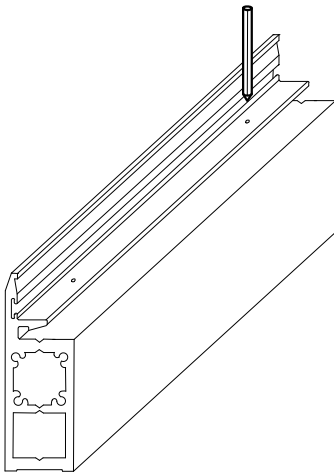
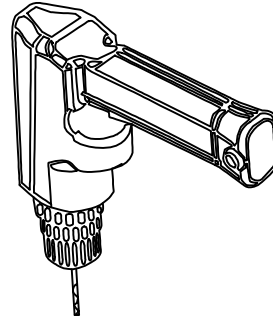

①

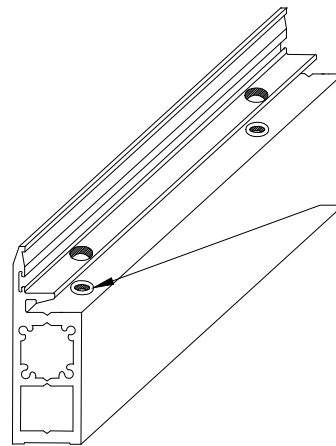

10mm Dia
Countersunk hole

②

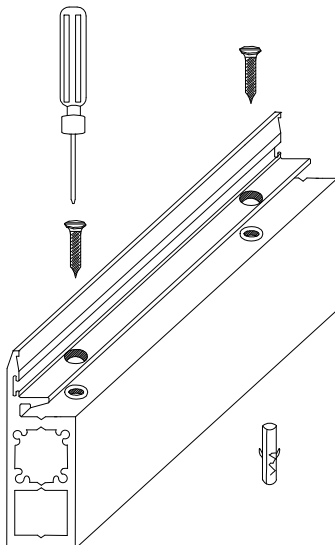

③



Century
SELF **LOCK**™
PATENTED
Glazing System

Disclaimer :
- All Dimensions are indicative
- Adequate structural support for suitable glass dimensions must be considered by the design engineer
- SELFLOCK Systems responsible only for the performance of the locking mechanism of genuine products & assume no responsibility for the incorrect usage of the system

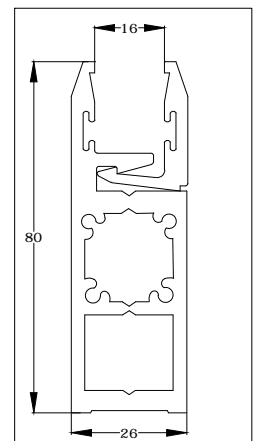

SELF-LOCK BOTTOM PRO

(COMBINATION WITH SINGLE PRO AT SIDES & TOP)

2. Push in the contact profile

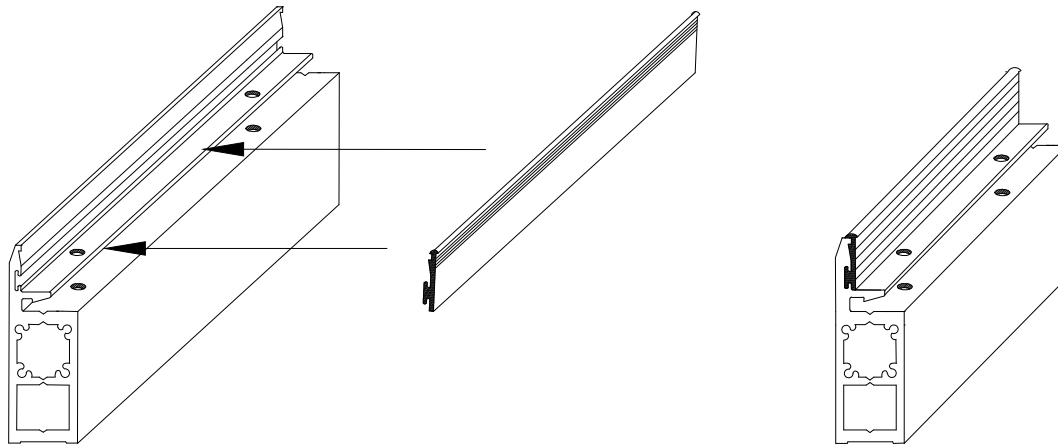

④

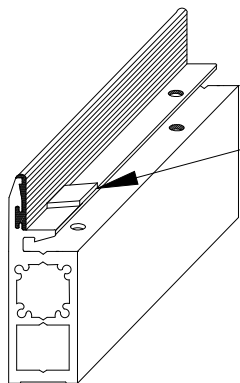

Setting Block Not included in scope of delivery.

⑤

6. Setting up the glass

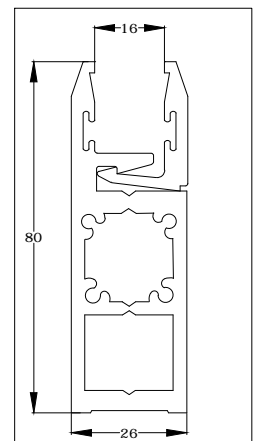
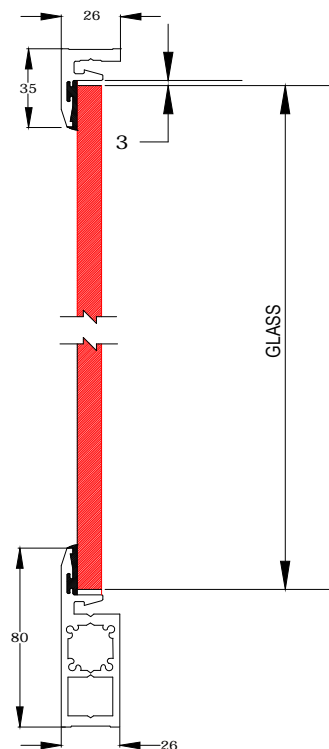

Disclaimer :
- All Dimensions are indicative
- Adequate structural support for suitable glass dimensions must be considered by the design engineer
- SELFLOCK Systems responsible only for the performance of the locking mechanism of genuine products & assume no responsibility for the incorrect usage of the system

SELF-LOCK BOTTOM PRO

(COMBINATION WITH SINGLE PRO AT SIDES & TOP)

3. Assemble the clamping profile 2 and attach the glass wedge profile

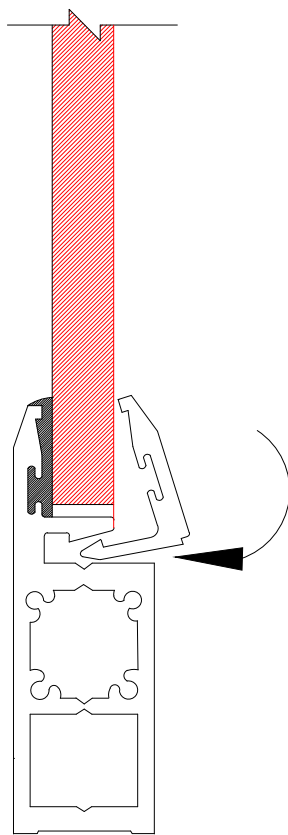

⑦

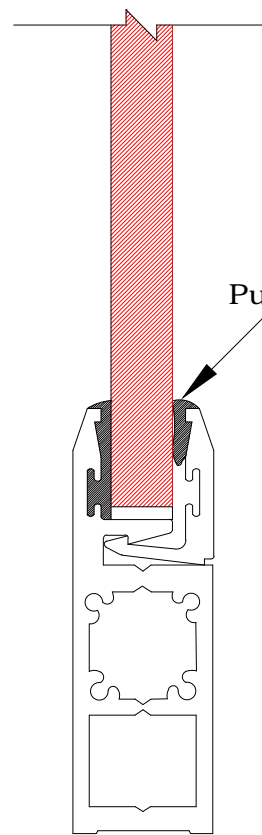

⑧

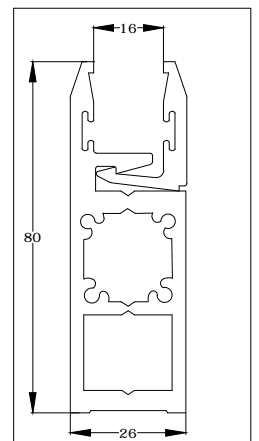

SELF- LOCK T-PRO FOR TRANSOM

(COMBINATION WITH BOTTOM PRO OR SINGLE PRO)

Important Information

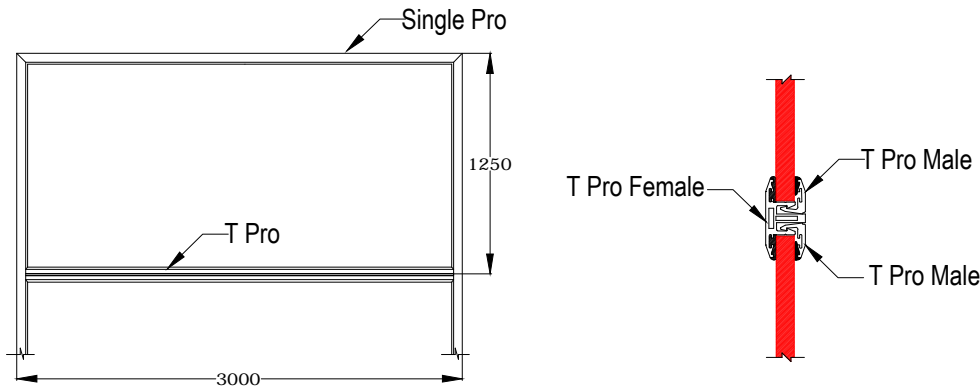

All glass clamping areas are to be cleaned with standard glass cleaning products prior to installation.



do not use thinners

Assembly tool:

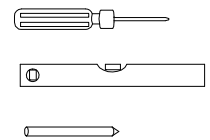
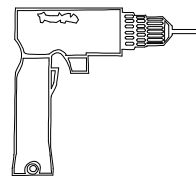

Scope of delivery:

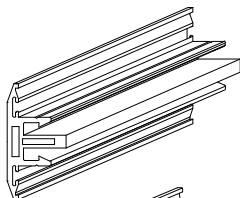

Wall connecting profile(female)

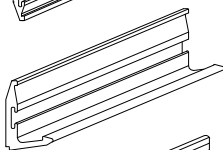

Clamping profile(male)



Contact profile(EPDM Std. Rubber)-non removable after the glass installed.



Glass wedge profile for 12 mm glass(EPDM Lock Rubber for 12mm glass)



Glass wedge profile for 10mm glass(EPDM Lock Rubber for 10mm glass)

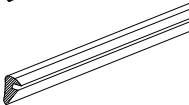

Glass wedge profile for 8 mm glass(EPDM Lock Rubber for 8mm glass)

Panel dimensions ideal for 10mm glass only.



Disclaimer :
 - All Dimensions are indicative
 - Adequate structural support for suitable glass dimensions must be considered by the design engineer
 - SELFLOCK Systems responsible only for the performance of the locking mechanism of genuine products & assume no responsibility for the incorrect usage of the system

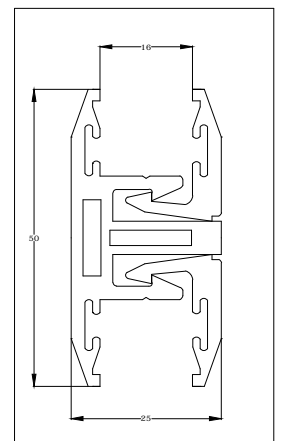

SELF- LOCK T-PRO FOR TRANSOM

(COMBINATION WITH BOTTOM PRO OR SINGLE PRO)

1.Assembly of the connecting profile



Screws and plugs for connection are not part of delivery!
please use suitable anchor system according to foundation



A level wall / substructure is a necessity for an assembly without problems.

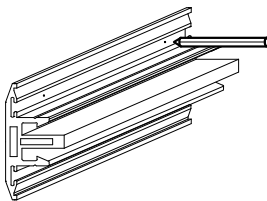

①

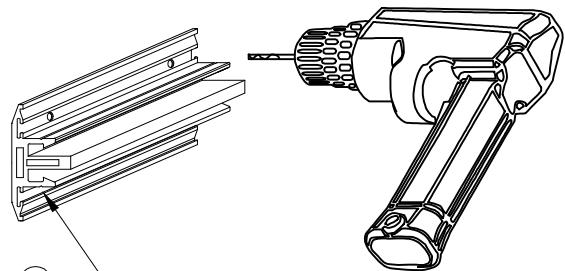

②

10mm Dia
Countersunk hole

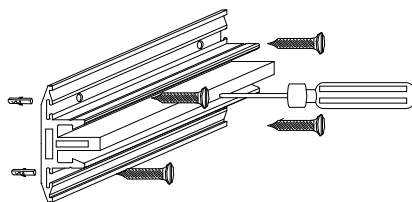

③

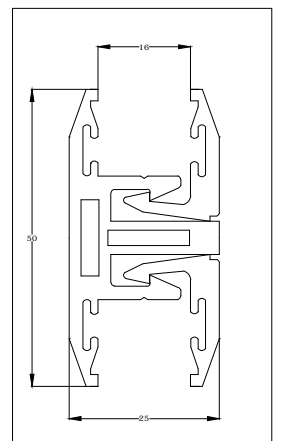

Disclaimer :
- All Dimensions are indicative
- Adequate structural support for suitable glass dimensions must be considered by the design engineer
- SELFLOCK Systems responsible only for the performance of the locking mechanism of genuine products & assume no responsibility for the incorrect usage of the system

SELF- LOCK T-PRO FOR TRANSOM (COMBINATION WITH BOTTOM PRO OR SINGLE PRO)

2.Push in the contact profile

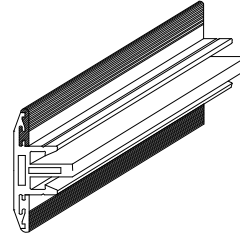
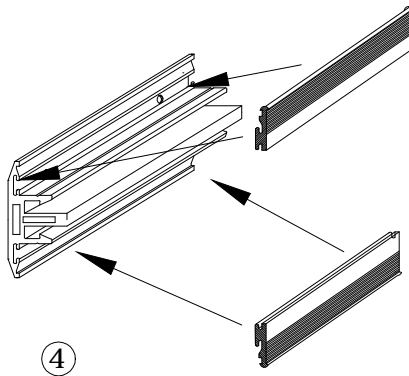

Setting up the glass:

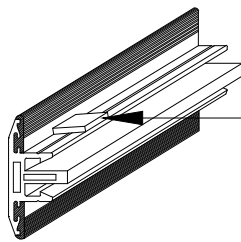

Setting Block Not included in scope of delivery.

⑤

6.Setting up the glass

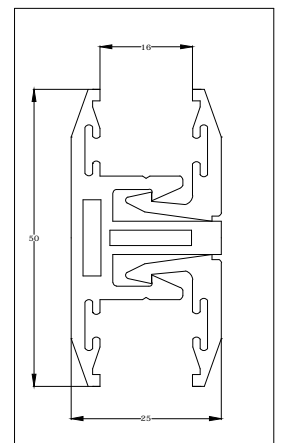
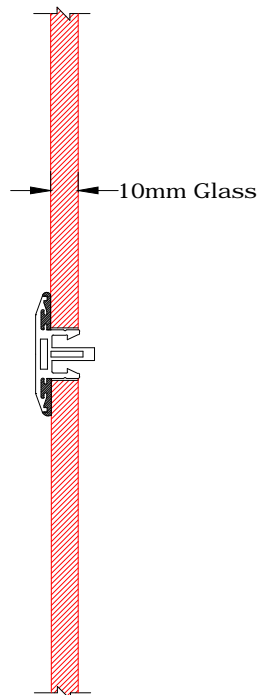

Century
SELF **LOCK**TM
PATENTED
Glazing System

Disclaimer :
- All Dimensions are indicative
- Adequate structural support for suitable glass dimensions must be considered by the design engineer
- SELFLOCK Systems responsible only for the performance of the locking mechanism of genuine products & assume no responsibility for the incorrect usage of the system

SELF- LOCK T-PRO FOR TRANSOM

(COMBINATION WITH BOTTOM PRO OR SINGLE PRO)

3. Assemble the clamping profile 2 and attach the glass wedge profile

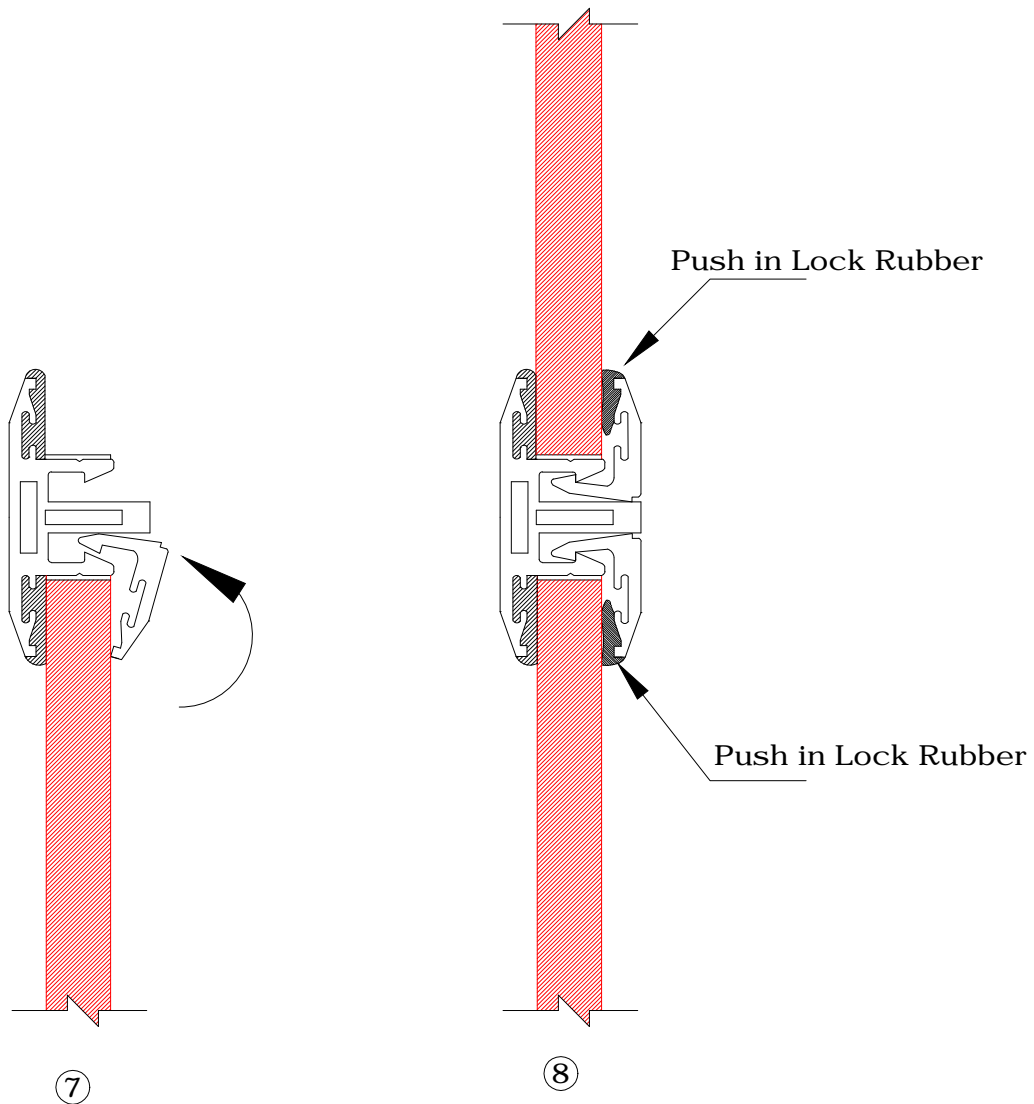

Disclaimer :
- All Dimensions are indicative
- Adequate structural support for suitable glass dimensions must be considered by the design engineer
- SELFLOCK Systems responsible only for the performance of the locking mechanism of genuine products & assume no responsibility for the incorrect usage of the system

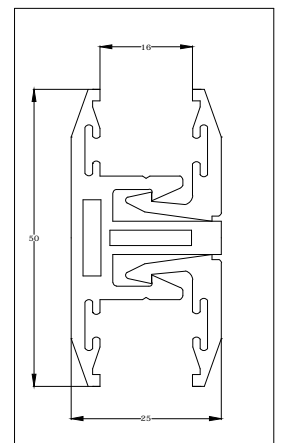

SELF-LOCK LITE PRO

Important Information

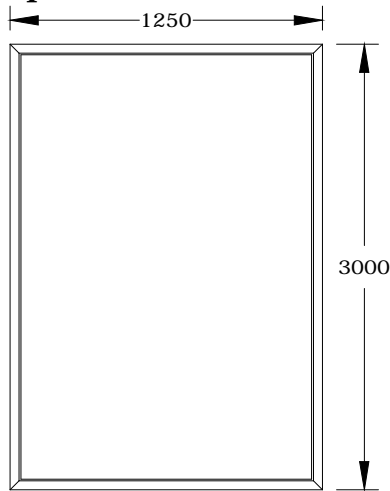

All glass clamping areas are to be cleaned with standard glass cleaning products prior to installation.



do not use thinners

Assembly tool:

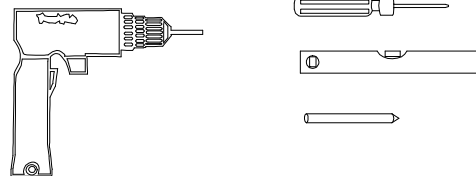

Scope of delivery:

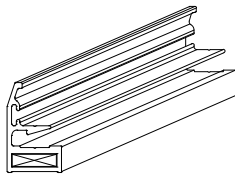

Wall connecting
profile(female)

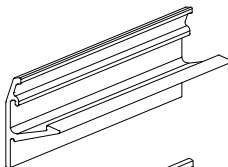

Clamping
profile(male)

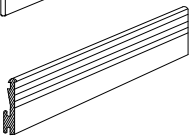

Contact profile(EPDM Std. Rubber)-non
removable after the glass installed.

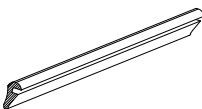

Glass wedge profile for 6 mm glass(EPDM Lock Rubber for
6mm glass)

Panel dimensions ideal for 6mm
glass only.



Disclaimer :
- All Dimensions are indicative
- Adequate structural support for suitable glass dimensions must be considered by the design engineer
- SELFLOCK Systems responsible only for the performance of the locking mechanism of genuine products & assume no responsibility for the incorrect usage of the system

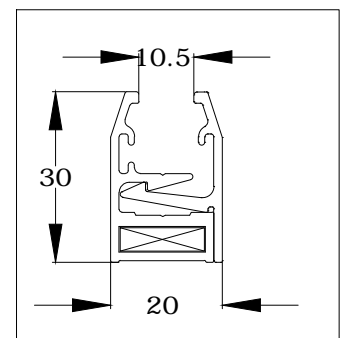

SELF-LOCK LITE PRO

1. Assembly of the connecting profile



Screws and plugs for connection are not part of delivery!
please use suitable anchorsystem according to
foundation



A level wall / substructure is a necessity for an
assembly without problems.

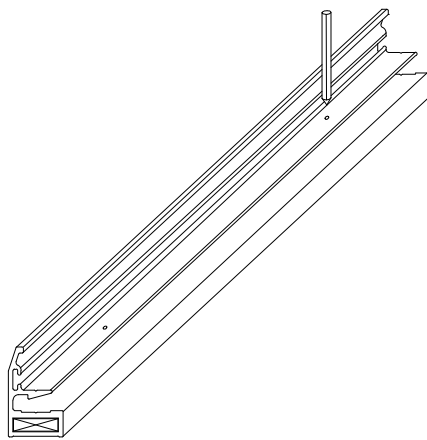

①

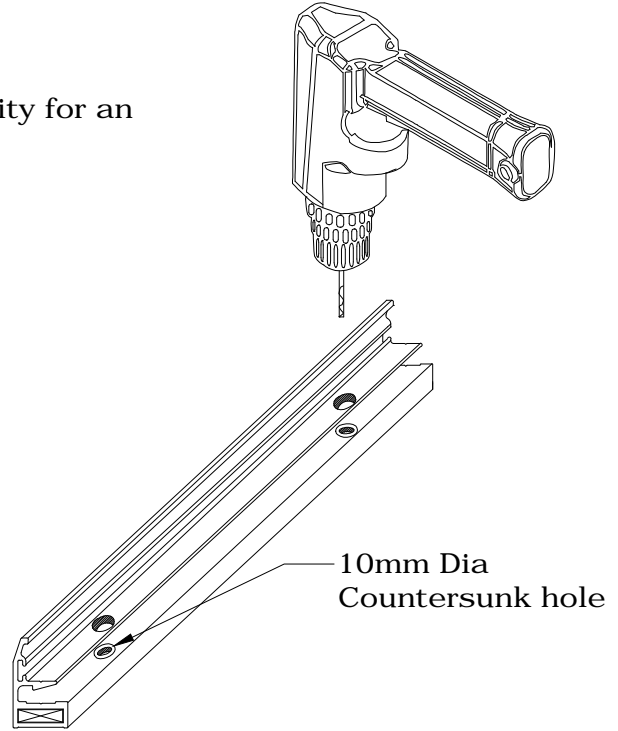

②

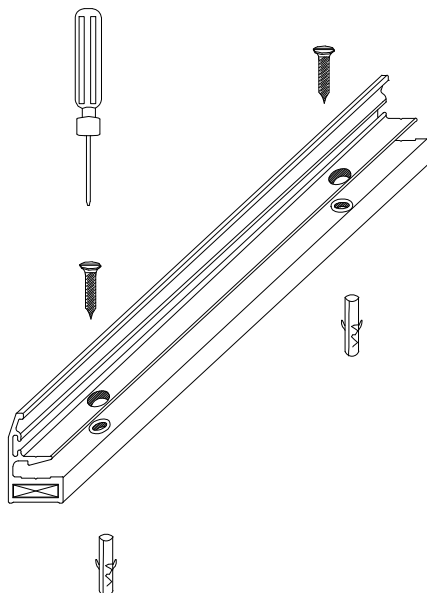

③

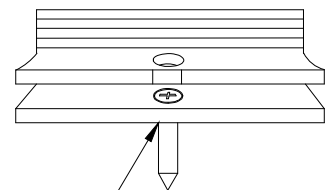

The screw head
must be flush or
completely sunk!



Disclaimer :
- All Dimensions are indicative
- Adequate structural support for suitable glass dimensions must be considered by the design engineer
- SELFLOCK Systems responsible only for the performance of the locking mechanism of genuine products & assume no responsibility for the incorrect usage of the system

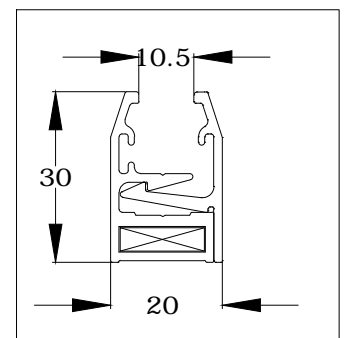

SELF-LOCK LITE PRO

2. Push in the contact profile

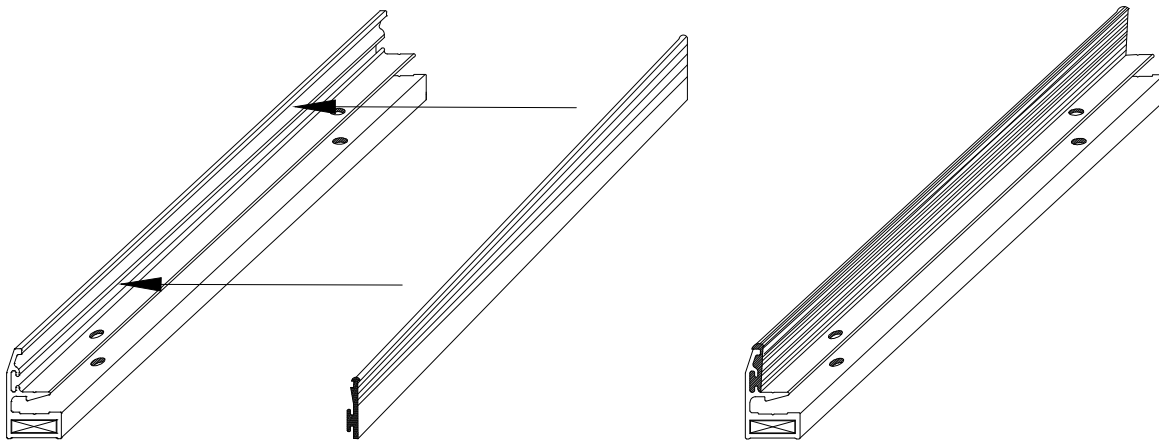

④

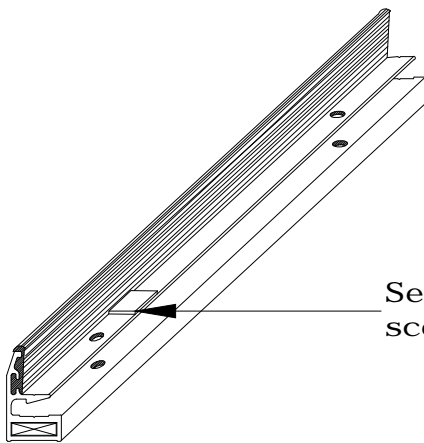

Setting Block Not included in scope of delivery.

⑤

6. Setting up the glass

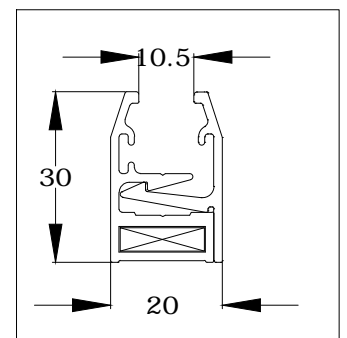
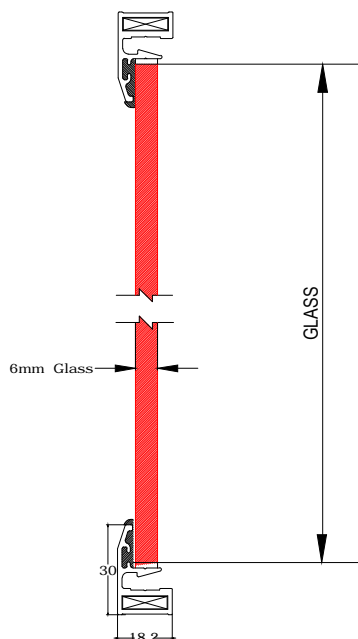

Century
SELF
PATENTED
LOCKTM
Glazing System

Disclaimer :
- All Dimensions are indicative
- Adequate structural support for suitable glass dimensions must be considered by the design engineer
- SELFLOCK Systems responsible only for the performance of the locking mechanism of genuine products & assume no responsibility for the incorrect usage of the system

SELF-LOCK LITE PRO

3. Assemble the clamping profile 2 and attach the glass wedge profile

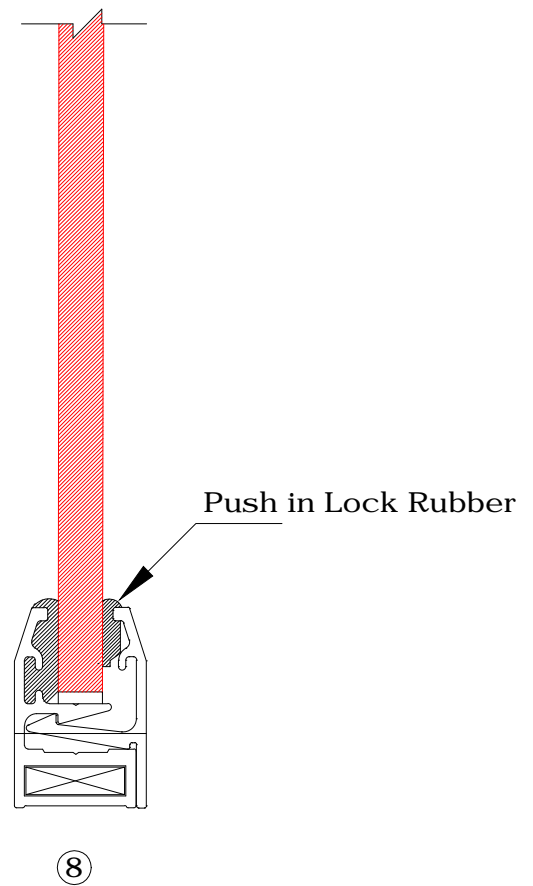
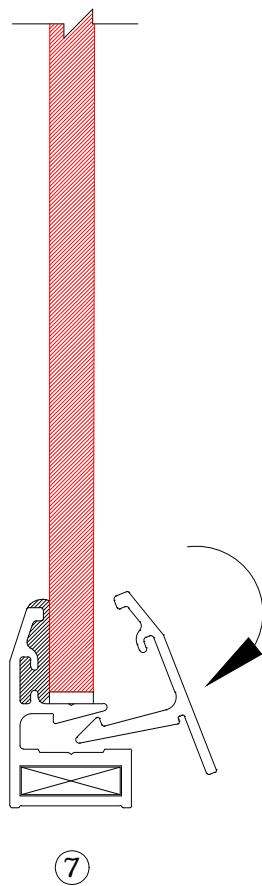

Disclaimer :
- All Dimensions are indicative
- Adequate structural support for suitable glass dimensions must be considered by the design engineer
- SELFLOCK Systems responsible only for the performance of the locking mechanism of genuine products & assume no responsibility for the incorrect usage of the system

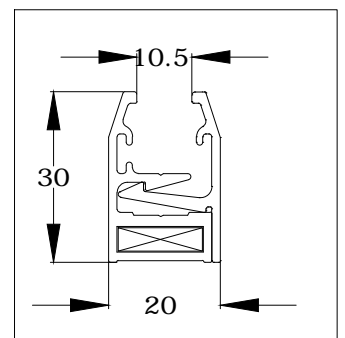

SELF-LOCK DOUBLE PRO

Important Information

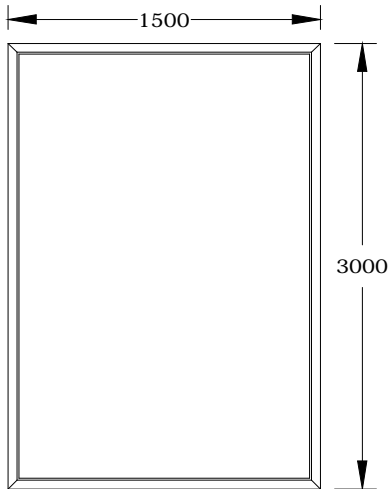

All glass clamping areas are to be cleaned with standard glass cleaning products prior to installation.



do not use thinners

Assembly tool:

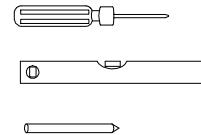
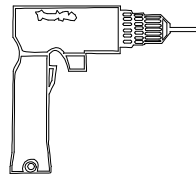

Scope of delivery:

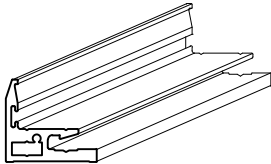

Wall connecting profile(female)

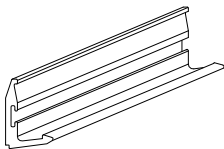

Clamping profile(male)

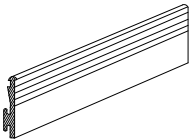

Contact profile(EPDM Std. Rubber)-non removable after the glass installed.

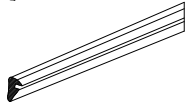

Glass wedge profiles for 22 -24 mm Double glazed (DGU)
Available for stated combinations (8-10-6 or 6-12-6 or 6-10-6)
NOTE: Suitable EPDM Wedges available on request



Disclaimer :
- All Dimensions are indicative
- Adequate structural support for suitable glass dimensions must be considered by the design engineer
- SELFLOCK Systems responsible only for the performance of the locking mechanism of genuine products & assume no responsibility for the incorrect usage of the system

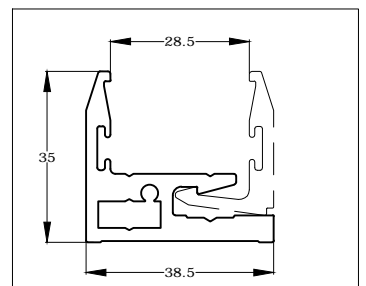

SELF-LOCK DOUBLE PRO

1. Assembly of the connecting profile



Screws and plugs for connection are not part of delivery!
please use suitable anchor system according to foundation



A level wall / substructure is a necessity for an assembly without problems.

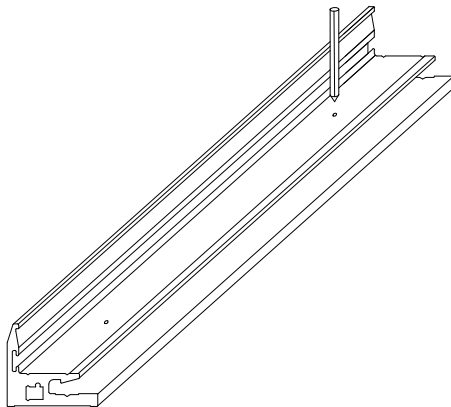
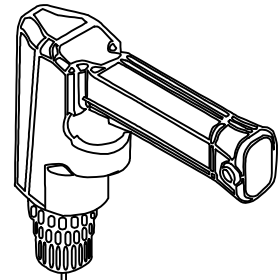

①

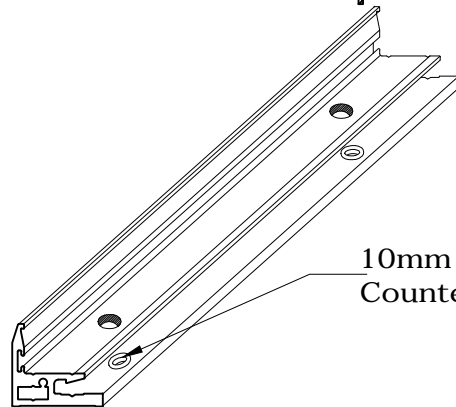

10mm Dia
Countersunk hole

②

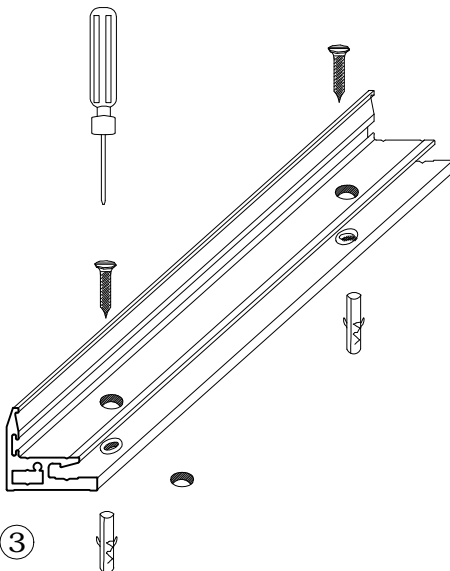

③

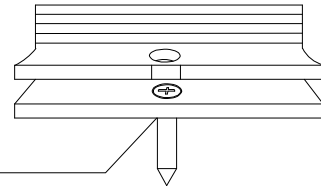

The screw head must be flush or completely sunk!



Disclaimer :
- All Dimensions are indicative
- Adequate structural support for suitable glass dimensions must be considered by the design engineer
- SELFLOCK Systems responsible only for the performance of the locking mechanism of genuine products & assume no responsibility for the incorrect usage of the system

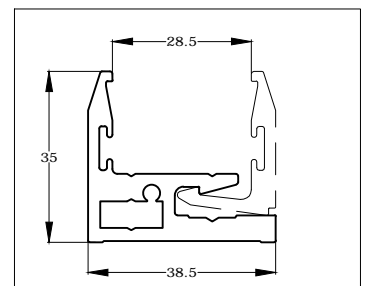

SELF-LOCK DOUBLE PRO

2. Push in the contact profile

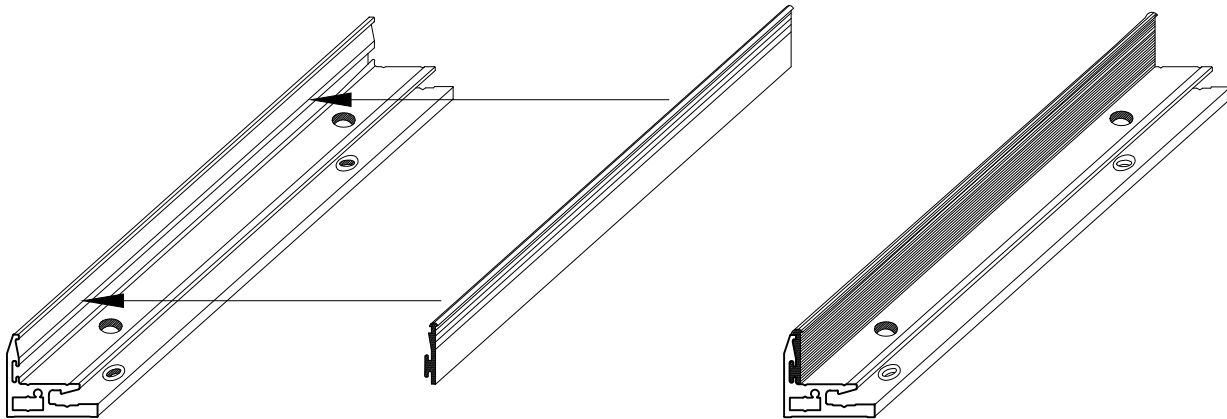

④

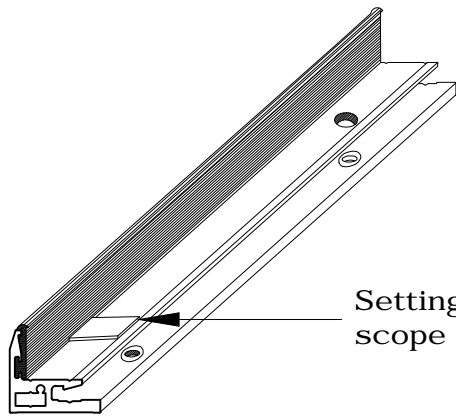

Setting Block Not included in scope of delivery.

⑤

6. Setting up the glass

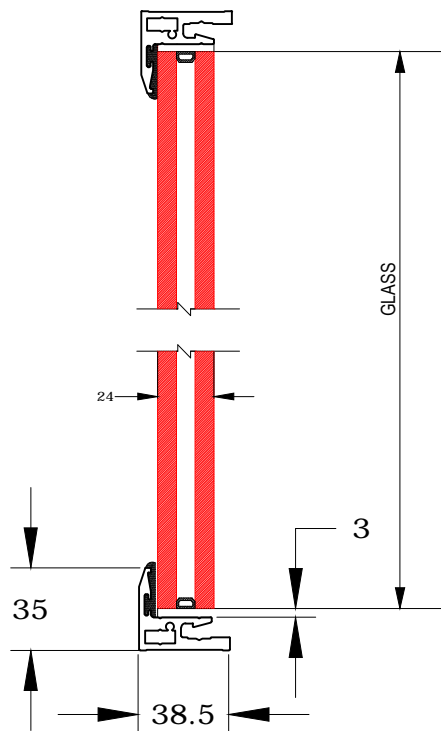

Disclaimer :
- All Dimensions are indicative
- Adequate structural support for suitable glass dimensions must be considered by the design engineer
- SELFLOCK Systems responsible only for the performance of the locking mechanism of genuine products & assume no responsibility for the incorrect usage of the system

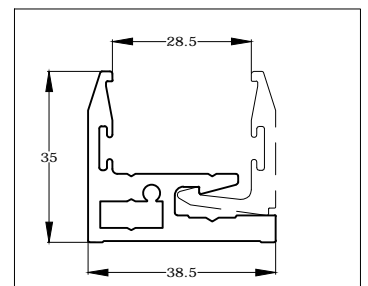

SELF-LOCK DOUBLE PRO

3. Assemble the clamping profile 2 and attach the glass wedge profile

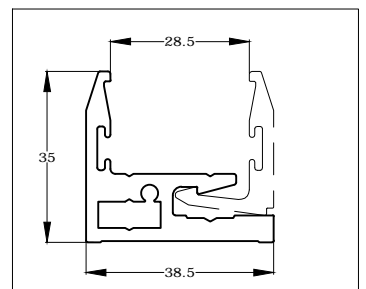
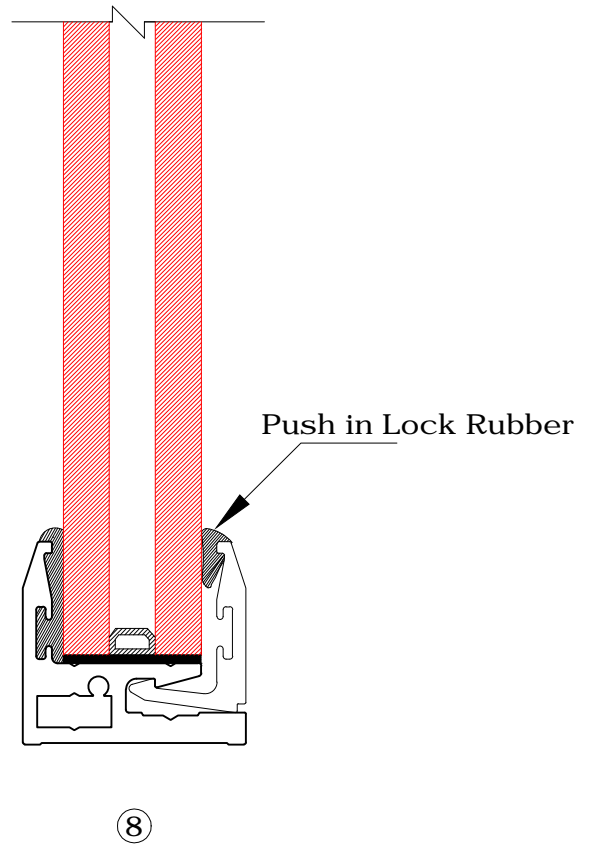
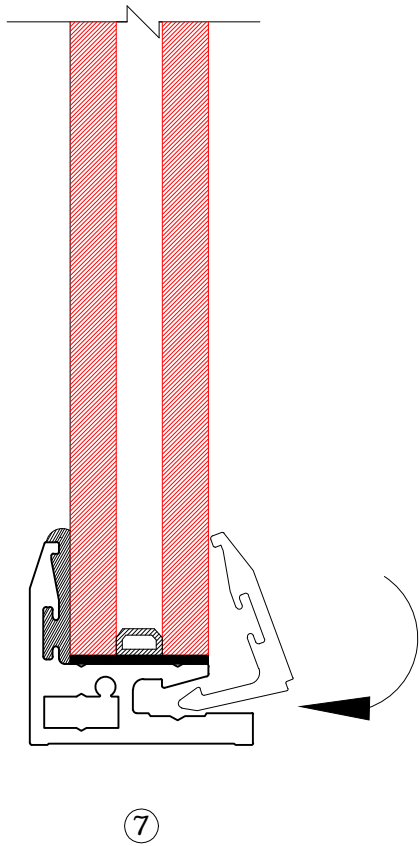

SELF-LOCK FANCY PRO

Important Information

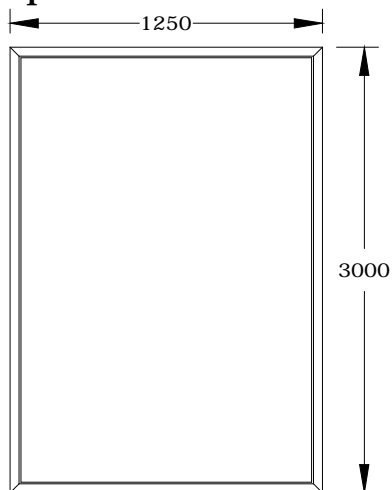

All glass clamping areas are to be cleaned with standard glass cleaning products prior to installation.



do not use thinners

Assembly tool:

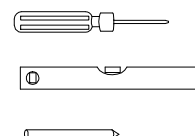
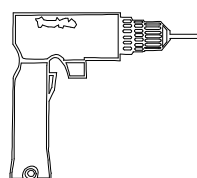

Scope of delivery:

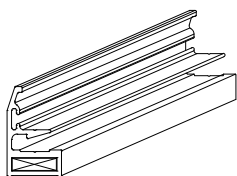

Wall connecting profile(female)

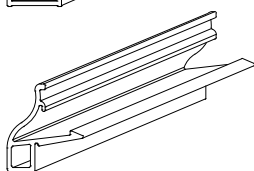

Clamping profile(male)

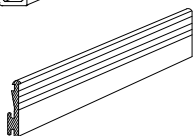

Contact profile(EPDM Std. Rubber)-non removable after the glass installed.

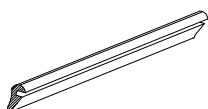

Glass wedge profile for 6 mm glass(EPDM Lock Rubber for 6mm glass)

Panel dimensions ideal for 6mm glass only.



Disclaimer :
- All Dimensions are indicative
- Adequate structural support for suitable glass dimensions must be considered by the design engineer
- SELFLOCK Systems responsible only for the performance of the locking mechanism of genuine products & assume no responsibility for the incorrect usage of the system

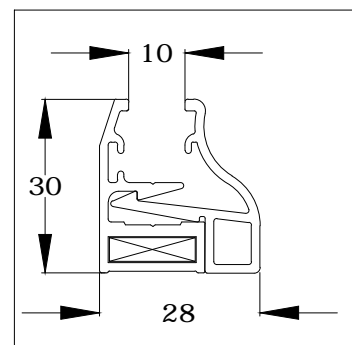

SELF-LOCK FANCY PRO

1.Assembly of the connecting profile



Screws and plugs for connection are not part of delivery!
please use suitable anchorsystem according to
foundation



A level wall / substructure is a necessity for an
assembly without problems.

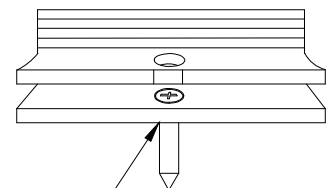
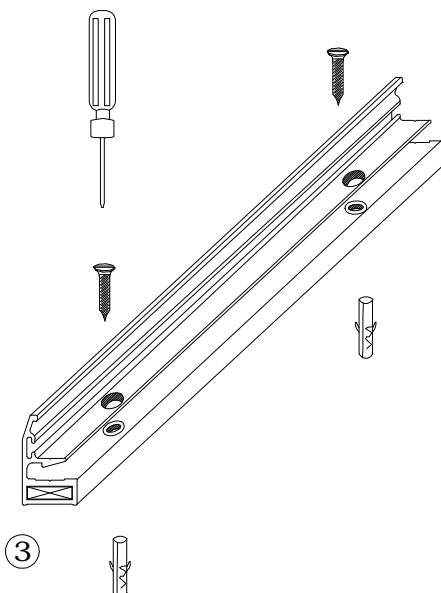
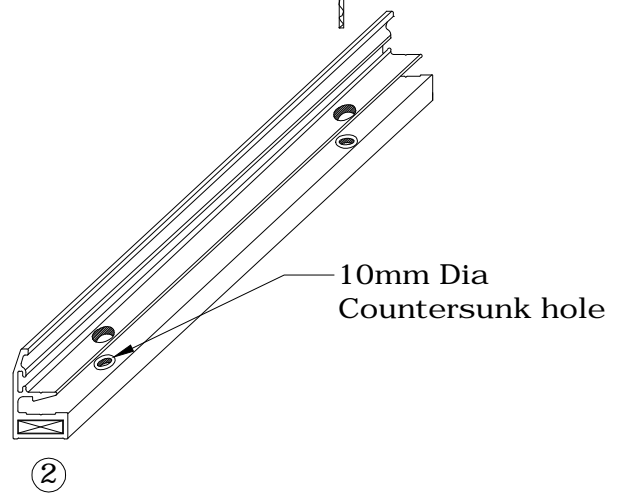
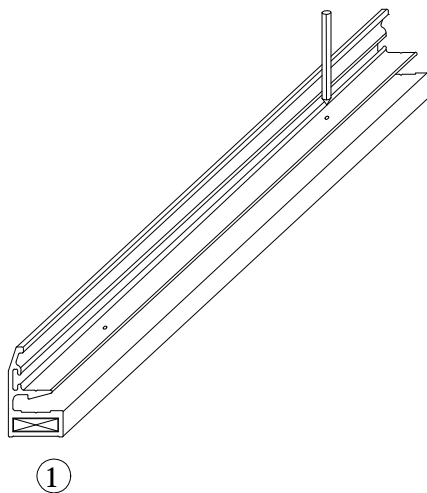
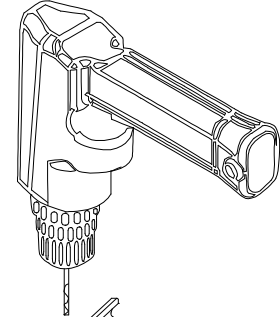

The screw head
must be flush or
completely sunk!

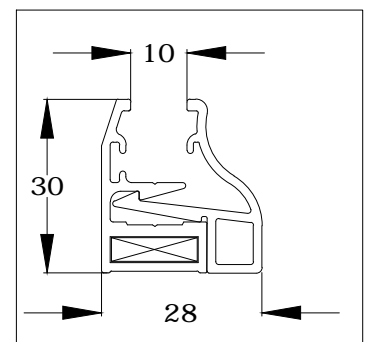

Century
SELF **LOCK**TM
PATENTED
Glazing System

Disclaimer :
- All Dimensions are indicative
- Adequate structural support for suitable glass dimensions must be considered by the design engineer
- SELFLOCK Systems responsible only for the performance of the locking mechanism of genuine products & assume no responsibility for the incorrect usage of the system

SELF-LOCK FANCY PRO

2. Push in the contact profile

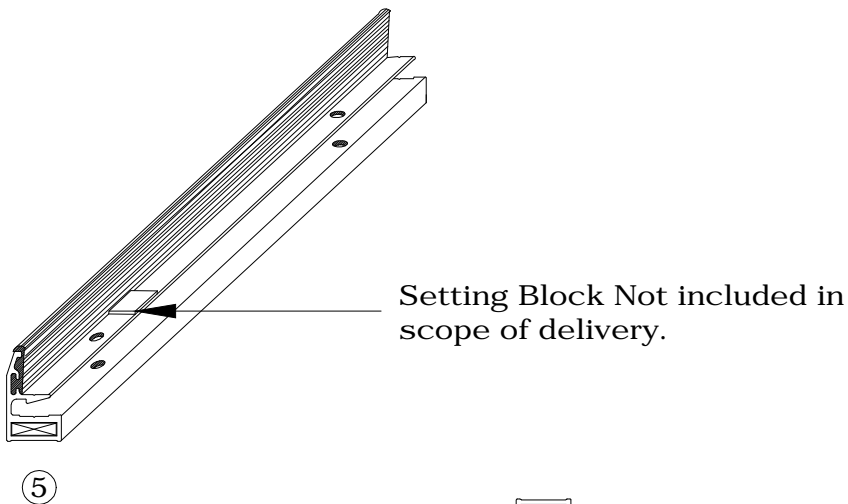
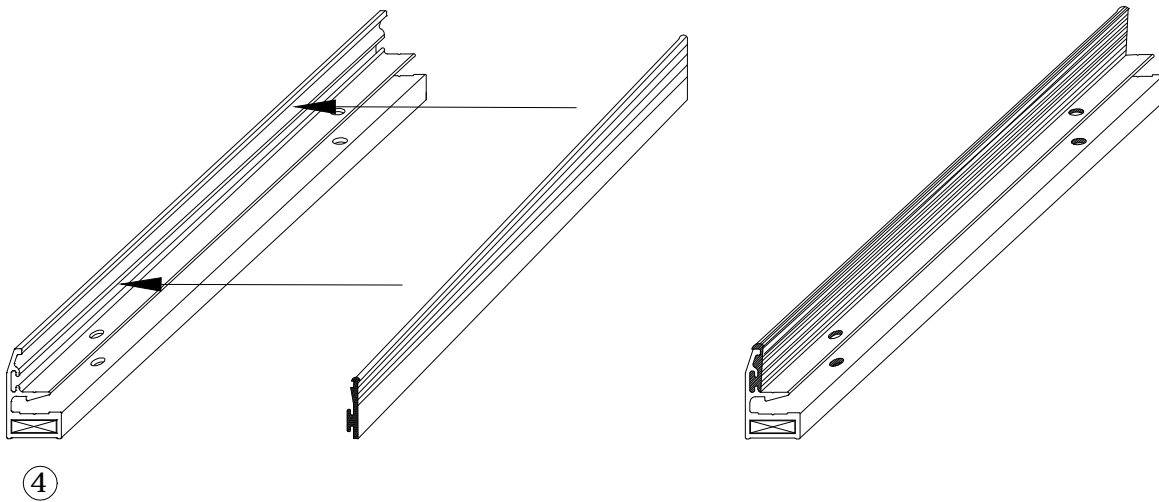

6. Setting up the glass

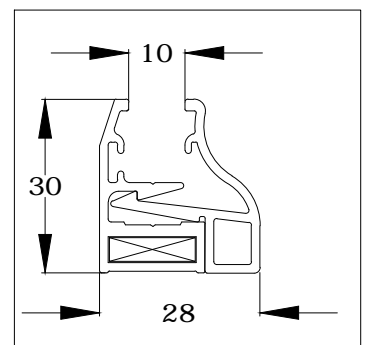
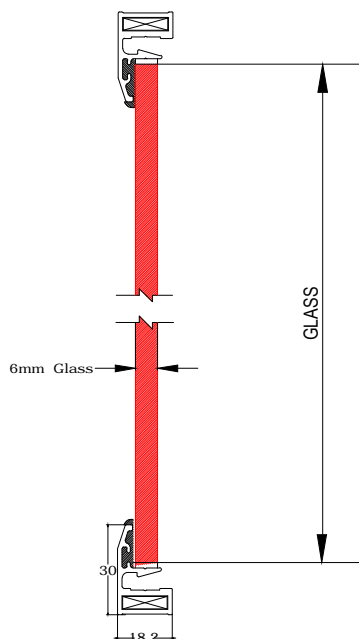

Century
SELF
PATENTED
LOCKTM
Glazing System

Disclaimer :
- All Dimensions are indicative
- Adequate structural support for suitable glass dimensions must be considered by the design engineer
- SELFLOCK Systems responsible only for the performance of the locking mechanism of genuine products & assume no responsibility for the incorrect usage of the system

SELF-LOCK FANCY PRO

3. Assemble the clamping profile 2 and attach the glass wedge profile

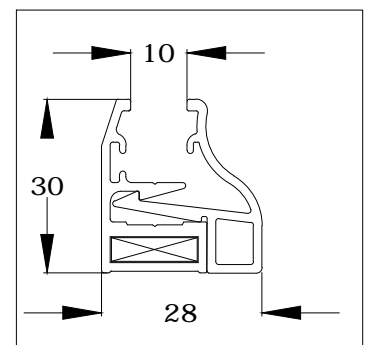
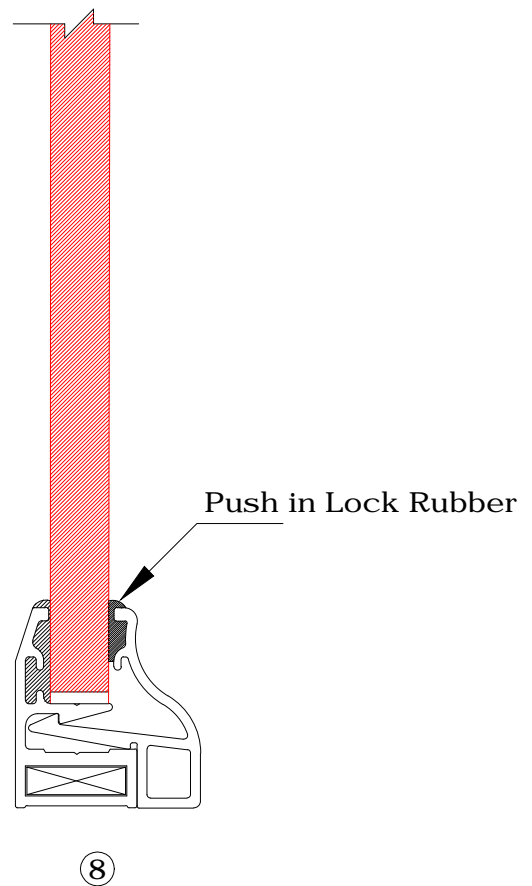
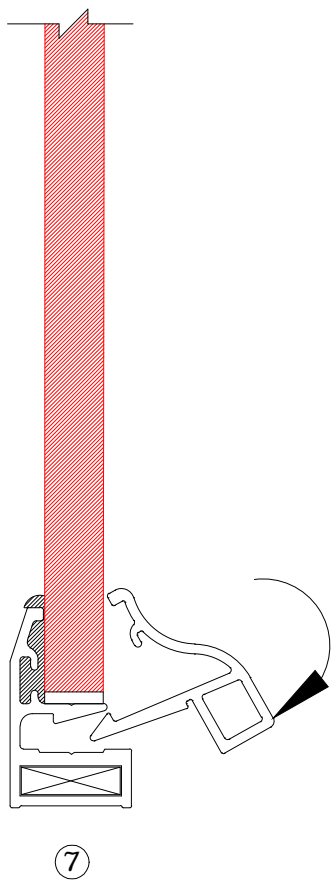

SELF-LOCK LITE PRO

Important Information

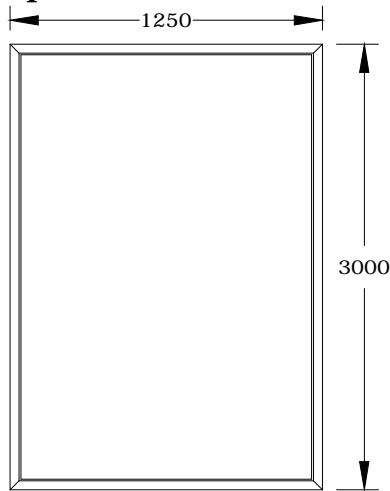

All glass clamping areas are to be cleaned with standard glass cleaning products prior to installation.



do not use thinners

Assembly tool:

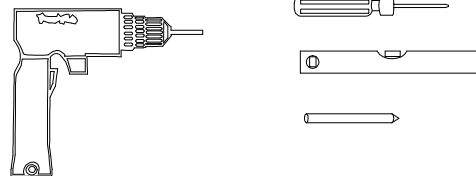

Scope of delivery:

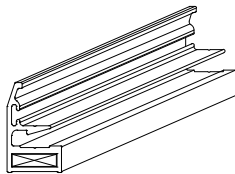

Wall connecting
profile(female)

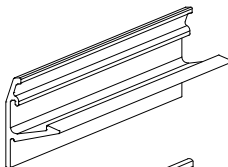

Clamping
profile(male)

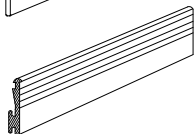

Contact profile(EPDM Std. Rubber)-non
removable after the glass installed.

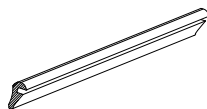

Glass wedge profile for 6 mm glass(EPDM Lock Rubber for
6mm glass)

Panel dimensions ideal for 6mm
glass only.



Disclaimer :
- All Dimensions are indicative
- Adequate structural support for suitable glass dimensions must be considered by the design engineer
- SELFLOCK Systems responsible only for the performance of the locking mechanism of genuine products & assume no responsibility for the incorrect usage of the system

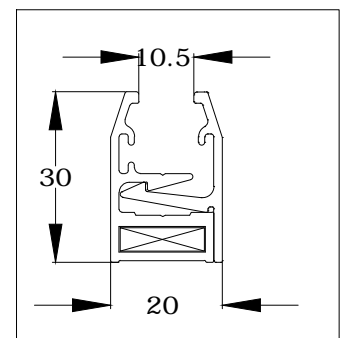

SELF-LOCK LITE PRO

1. Assembly of the connecting profile



Screws and plugs for connection are not part of delivery!
please use suitable anchorsystem according to
foundation



A level wall / substructure is a necessity for an
assembly without problems.

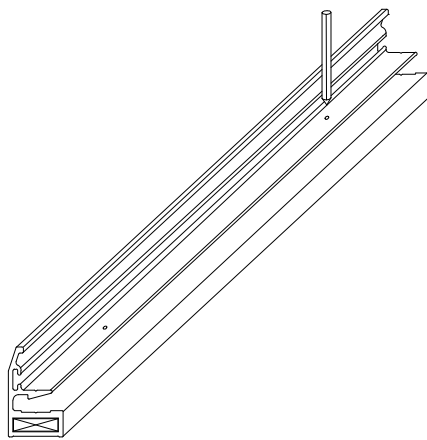

①

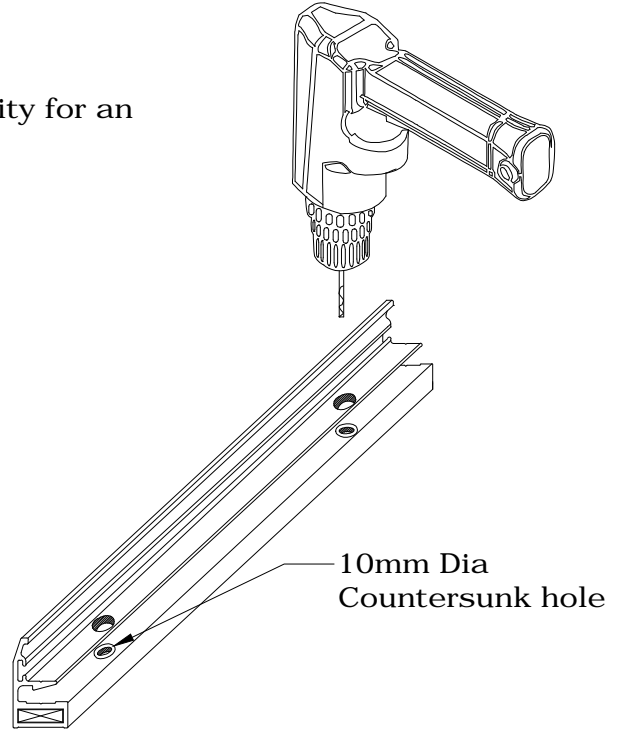

②

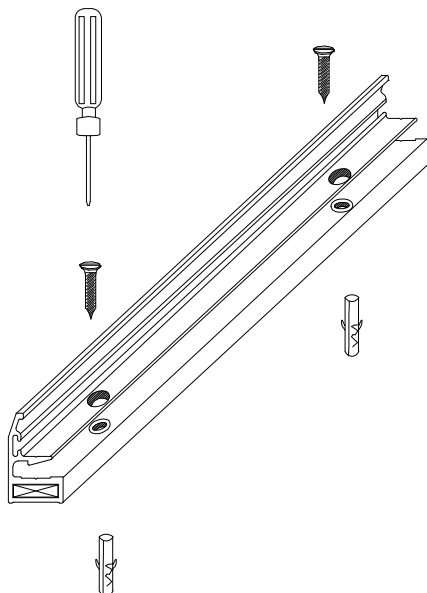

③

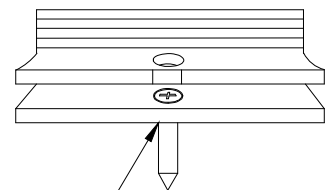

The screw head
must be flush or
completely sunk!



Disclaimer :
- All Dimensions are indicative
- Adequate structural support for suitable glass dimensions must be considered by the design engineer
- SELFLOCK Systems responsible only for the performance of the locking mechanism of genuine products & assume no responsibility for the incorrect usage of the system

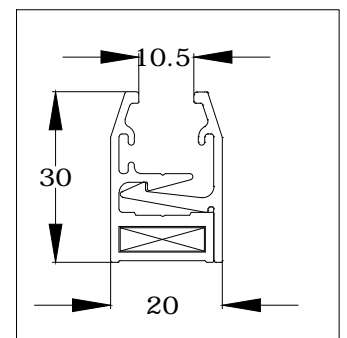

SELF-LOCK LITE PRO

2. Push in the contact profile

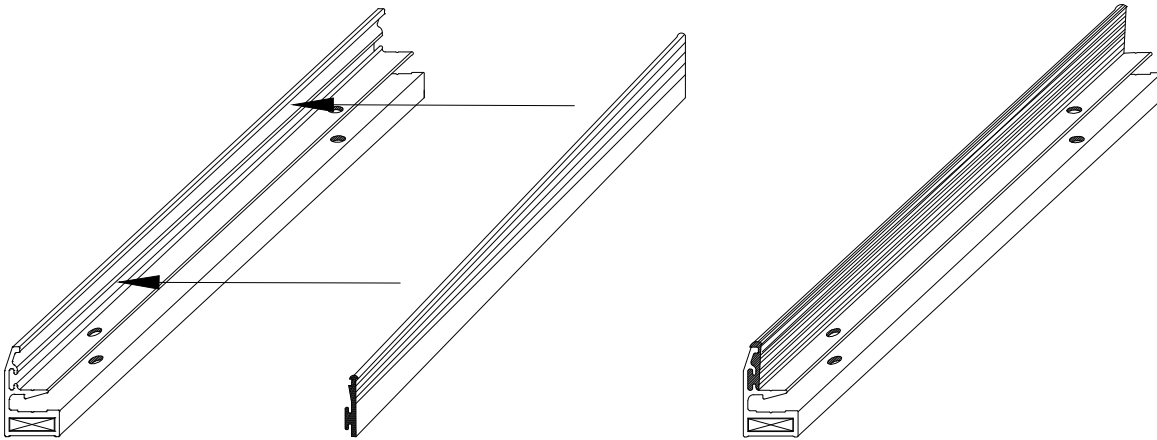

④

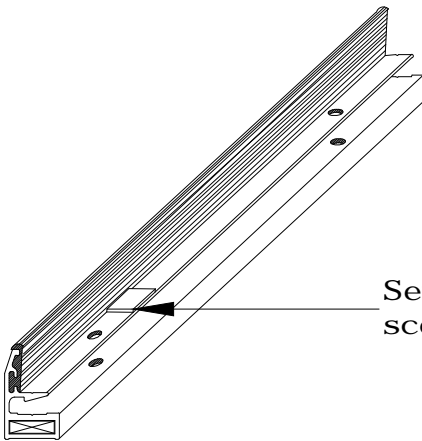

Setting Block Not included in scope of delivery.

⑤

6. Setting up the glass

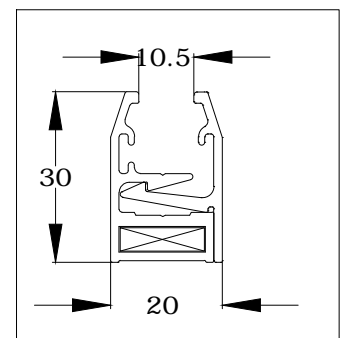
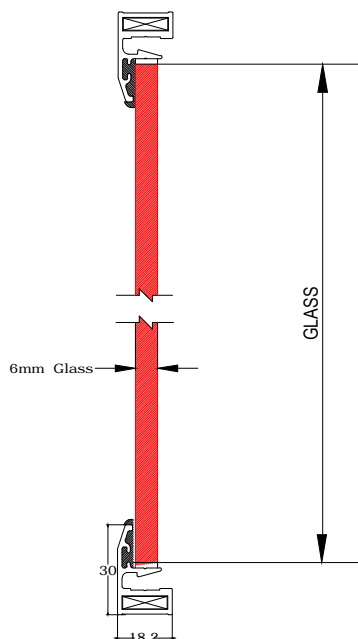

Century
SELF **LOCK**TM
PATENTED
Glazing System

Disclaimer :
- All Dimensions are indicative
- Adequate structural support for suitable glass dimensions must be considered by the design engineer
- SELFLOCK Systems responsible only for the performance of the locking mechanism of genuine products & assume no responsibility for the incorrect usage of the system

SELF-LOCK LITE PRO

3. Assemble the clamping profile 2 and attach the glass wedge profile

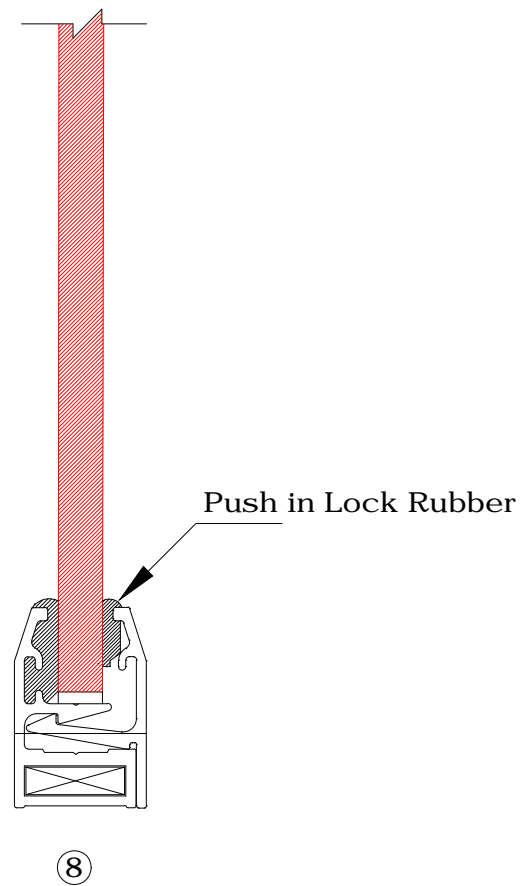
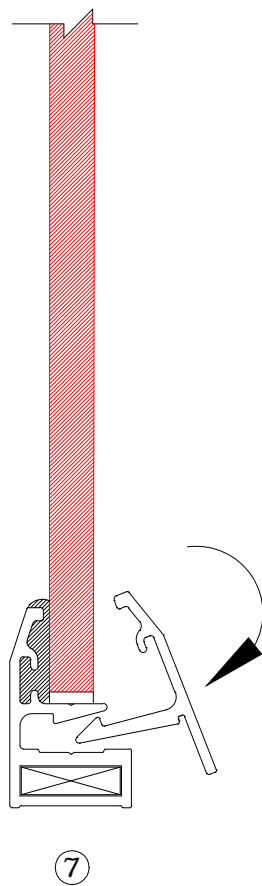

Disclaimer :
- All Dimensions are indicative
- Adequate structural support for suitable glass dimensions must be considered by the design engineer
- SELFLOCK Systems responsible only for the performance of the locking mechanism of genuine products & assume no responsibility for the incorrect usage of the system

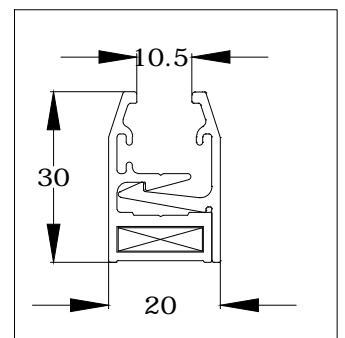

SELF- LOCK BLIND PRO

Important Information

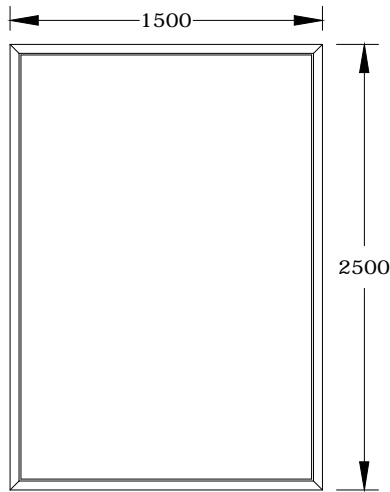

All glass clamping areas are to be cleaned with standard glass cleaning products prior to installation.



do not use thinners

Assembly tool:

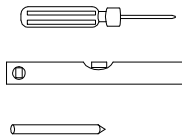
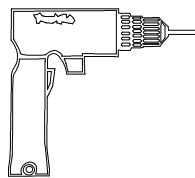

Scope of delivery:

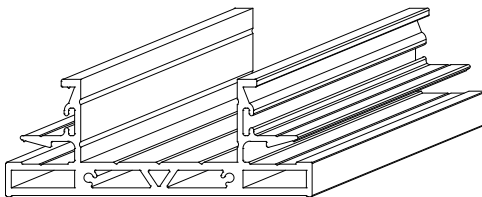

Wall connecting profile(female)

Panel dimensions ideal for 6mm glass only.

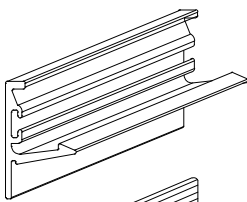

Clamping profile(male)

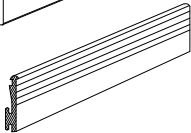

Contact profile(EPDM Std. Rubber)-non removable after the glass installed.

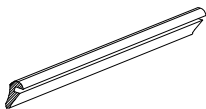

Glass wedge profile for 6 mm glass(EPDM Lock Rubber for 6mm glass)

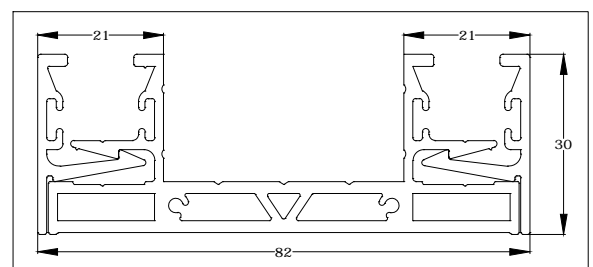

Disclaimer :
- All Dimensions are indicative
- Adequate structural support for suitable glass dimensions must be considered by the design engineer
- SELFLOCK Systems responsible only for the performance of the locking mechanism of genuine products & assume no responsibility for the incorrect usage of the system

SELF- LOCK BLIND PRO

1.Assembly of the connecting profile



Screws and plugs for connection are not part of delivery!
please use suitable anchor system according to foundation



A level wall / substructure is a necessity for an assembly without problems.

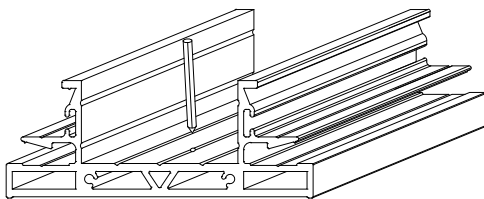
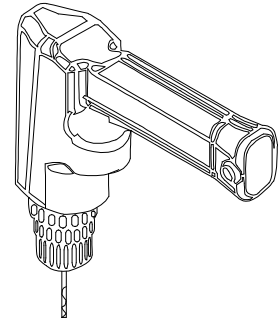

①

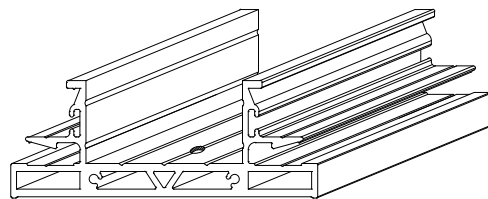

②

10mm Dia
Countersunk hole

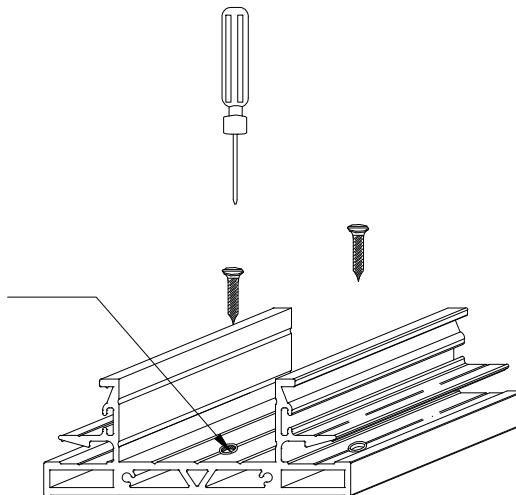

③

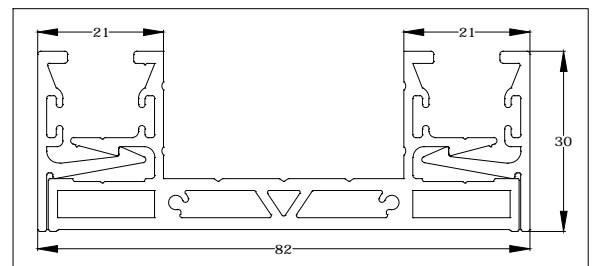

Century
SELF **LOCK**TM
PATENTED
Glazing System

Disclaimer :
- All Dimensions are indicative
- Adequate structural support for suitable glass dimensions must be considered by the design engineer
- SELFLOCK Systems responsible only for the performance of the locking mechanism of genuine products & assume no responsibility for the incorrect usage of the system

SELF- LOCK BLIND PRO

2.Push in the contact profile

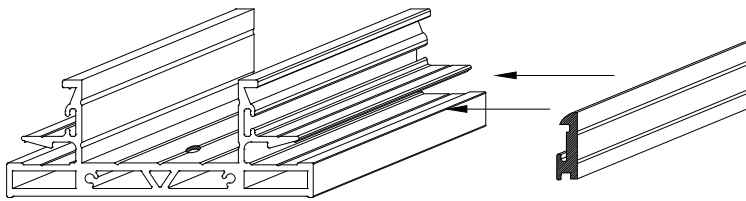

④

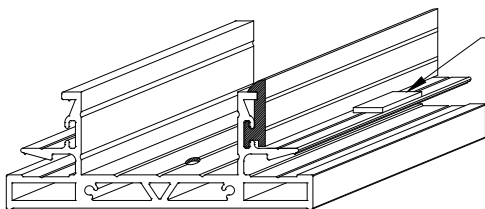
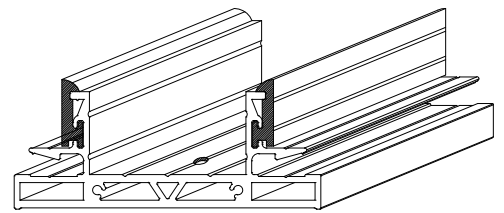

⑤

Setting Block Not included in scope of delivery.

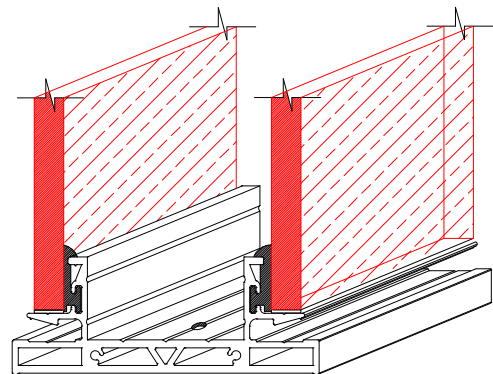

6.Setting up the glass:



Disclaimer :
- All Dimensions are indicative
- Adequate structural support for suitable glass dimensions must be considered by the design engineer
- SELFLOCK Systems responsible only for the performance of the locking mechanism of genuine products & assume no responsibility for the incorrect usage of the system

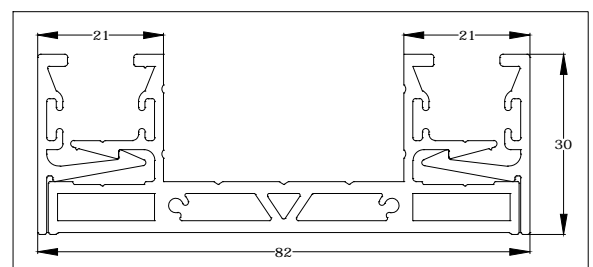

SELF- LOCK BLIND PRO

3. Assemble the clamping profile 2 and attach the glass wedge profile

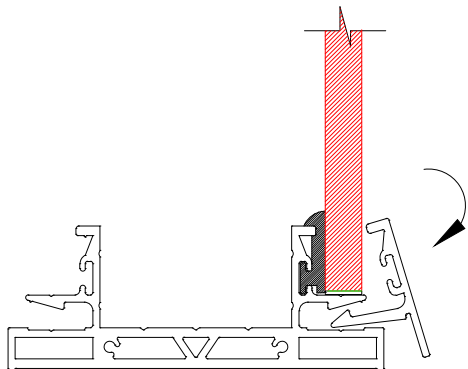

7

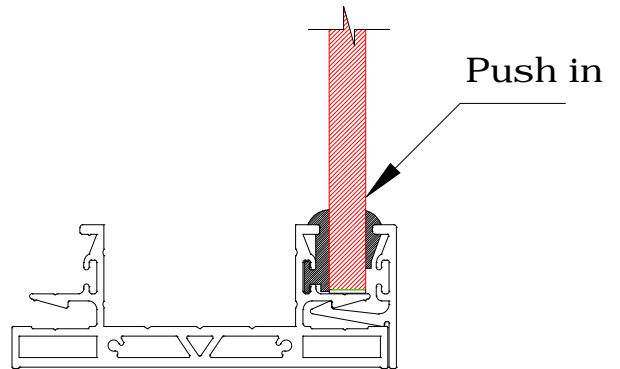

8

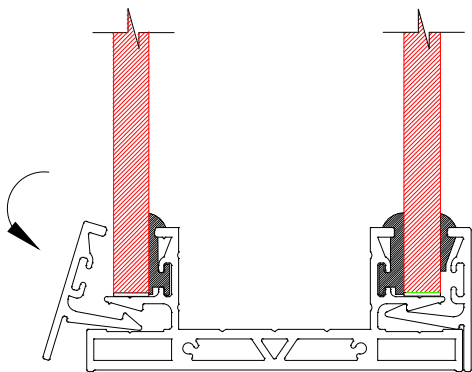

9

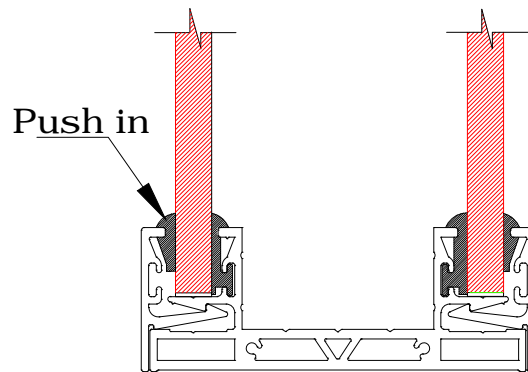

10



Disclaimer :
- All Dimensions are indicative
- Adequate structural support for suitable glass dimensions must be considered by the design engineer
- SELFLOCK Systems responsible only for the performance of the locking mechanism of genuine products & assume no responsibility for the incorrect usage of the system

